

# How to find the Bach House in Cöthen



A typical Smalltalk project

Georg Heeg, Cöthen

# Cöthen

- Traces of Dinosaurs
- Archeology trace back human culture until the Ice Age
  - Very fruitful since then
- Capital of an Independent Micro-State in the Center of Germany called Anhalt Cöthen
  - 1115 oldest document
  - 1855 merged with Anhalt Dessau
- App. 30,000 inhabitants
- Anhalt University of Applied Sciences
- City of the second biggest ESUG ever
  - 2004







# European Conference Smalltalk Technology





# Johann Sebastian Bach

- Pronounced [ˈjoːhan zeˈbastjan ˈbax]
- Now widely considered to be one of the greatest composers in the Western tradition
- Born March 21, 1685 in Eisenach
- Worked for Prince Leopold of Anhalt-Cöthen from 1717 to 1723
- Died July 28, 1750 in Leipzig





# Well Tempered Clavier

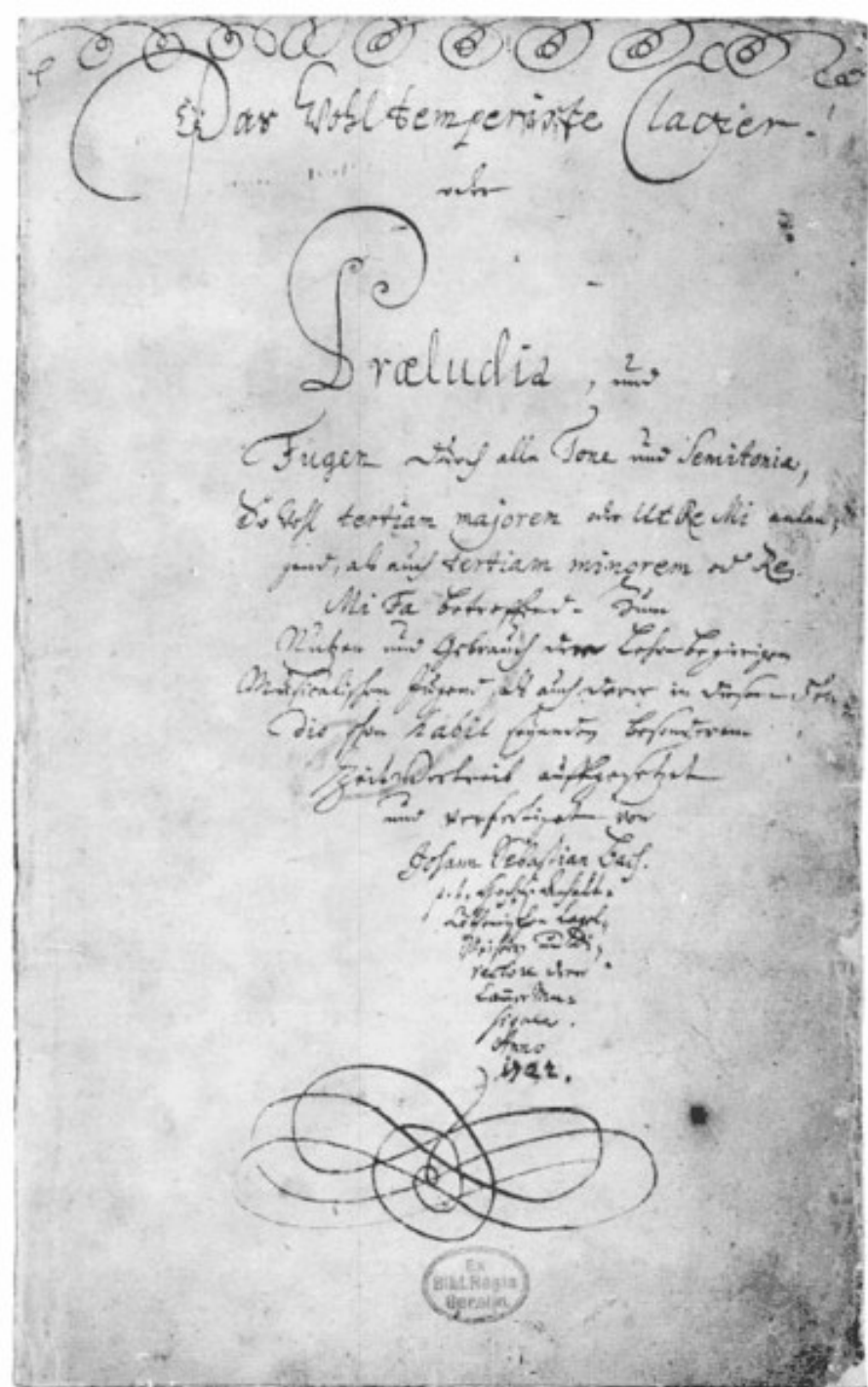

Clavier - Buchlein

Vor 2136

Anna Magdalena Bachin

Anno 1722.

B

Ante Calvinismus und  
Episcop. Disputa item  
Anti-Melancholicus } 29 D. Blätter.



Gavotte

Handwritten musical score for a piece titled "Gavotte". The score is written on six systems, each consisting of two staves. The notation is in a historical style, featuring various rhythmic values, accidentals, and dynamic markings. The first system begins with a treble clef and a common time signature. The second system includes a forte dynamic marking (*f*). The third system includes a *cha* marking above the staff. The fourth system includes a *f* marking below the staff. The fifth system includes a *f* marking below the staff. The sixth system includes a *f* marking below the staff. The score is written in black ink on aged, slightly yellowed paper.



# Johann Sebastian Bach in Cöthen

- Many open questions
- Bach lost popularity even during life time
- Popularity raised again 100 years after his death
- Bach research started around his 200<sup>th</sup> birthday in 1885
- But where did he live in Cöthen?
- This question has been open for 120+ years.



# Prince Leopold of Anhalt-Cöthen

- \* 29. November 1694 in Köthen (Anhalt)
- Hired Johann Sebastian Bach
- Enlarged the City of Köthen
  - West and East
- † 19. November 1728 in Köthen (Anhalt)



LEOPOLD,  
*Regierender Fürst zu Anhalt,  
Herzog zu Sachsen, Engern und  
Westphalen, Graf zu Ascanien,  
Herr zu Bernburg und Zerbst.*

# Bach as Tourist Attraction

- Köthener BachGesellschaft headed by
  - Georg Schäfer
    - Musical Director and CEO
  - Werner Sobetzko
    - Former State Minister of Culture
    - Member of the Board
- Decided to do a Feasibility Study
- Sponsored by
  - European Union
  - State of Anhalt-Saxony
  - Cöthen County and its legal successor Anhalt-Bitterfeld County
  - City of Cöthen



# How did Johann Sebastian Bach live and work in Cöthen?

- Example Questions

- **Bach's home in Cöthen**

- Cöthen's city structure
    - Structure of Cöthen's inhabitants
    - Bach's music creation in Cöthen
    - Life at the Prince's court in Cöthen

Köthener

bach GmbH

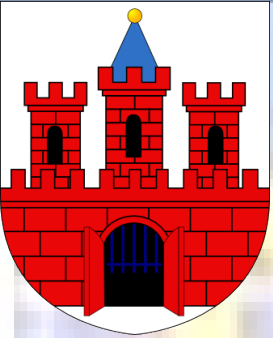

# Feasibility Study

about the further development of the  
tourist infrastructure in Cöthen with  
reference to the area of work and life of  
Johann Sebastian Bach



# Bidding

- Georg Heeg eK won the bidding for the computer part together with Anhalt University
- Georg Heeg eK
  - Founded in 1987
  - Oldest Smalltalk Only Company
  - Dortmund – Cöthen – Zurich
  - Mission: Excellence & Innovation



# Project Organization

- Project start 23 March 2006
- Project completion 15 February 2008



# Project Process

- 4 Phases
- Agile project methodology
- Exclusion as decision methodology
  - Turned out to be the key to project success
  - Very broad approach
    - E.g. Information about all Cöthen homes

# Phase 1

- Drill down to important questions
  - Brainstorming
  - Priorities



# Phase 2

- Collection of literature and documents
  - Based on phase 1
  - In libraries, antique book shops, eBay and archives
  - Scanning
  - OCR
    - Fine Reader
    - Word documents
  - Handwritten texts copied manually

# Documents

	documents	thereof on database	
Gothic font	151	23	15,23%
Latin font	510	446	87,45%
Handwriting	75	30	40,00%
Total	736	499	67,80%
	documents	thereof on database	
Gothic font	6427	1588	24,71%
Latin font	6971	6220	89,23%
Handwriting	763	336	44,04%
Total	14161	8144	57,51%

# Phase 3

- Construction of a semantic network with searching functionally
- Checking of ready systems
  - k-Infinity
    - Require too many manual steps
  - atlas-ti
    - Not extensible
  - Google Desktop
    - Not appropriate
- Own software called GH-Bachnetz



# GH-Bachnetz

- Developed according to the requirements of the project
  - Connection of automatic procedures with human decision taking
  - UI: Web-Browser
  - Representation of
    - Textual information with access to original documents
    - Network created from tax data
      - In tables
      - graphically
  - Development of GH-Bachnetz in parallel to usage
    - According to growing and changing requirements
    - Based on Smalltalk products VisualWorks, Seaside and GemStone/S
- Inner relations become visible
  - So far hidden in number and letter mountains

# Implementation environment

- Classic VisualWorks/GemStone architecture
  - VisualWorks has all the sophisticated
    - Seaside
    - Semantic Network
  - GemStone handles the persistence of masses
    - Searches in texts using Tries
      - Code taken from Java Spektrum Dynamic Languages Shootout Winner

# Kernel classes of the Semantic Network

- Object
  - Behavior
    - **ClassDescription**
      - Begriff
      - Relation
      - Wert
      - Class
      - Metaclass



# Class Begriff (Notion/Concept)

- Taken from class comment
  - Begriff is like a meta object.
  - It can have instances that are concrete and represent certain objects.
  - Those concrete instances can then have instances again that all share the same idea
- Special Notions are
  - Relation between other notions
  - Values

# Implementation of Class Begriff

- VisualWorks permits extending its meta model
  - Begriff is subclass of ClassDescription
  - A sister class to Class and Metaclass
- GemStone does not allow extending its meta model
  - When a network is stored in GemStone
    - Network description objects are created
  - When a network is read from GemStone
    - Network objects are recreated in VisualWorks

# A Specialty: Time

- Object
  - Magnitude
  - TemporalObject
  - TemporalInterval
    - TemporalMoment
    - TemporalYear



# Homes and inhabitants in Cöthen

- Data collection
  - Tax register (Schossregister)
    - 1710 to 1795, 1818 and 1819
  - Sketch of 1806
  - List of 1855
  - Detailed plan of 1855
  - Detailed plan 2003
  - Homage list (Huldigungsliste) of Prince Leopold (14 May 1716)
- Semantic Network provides
  - Complete list of home owners of 18th century with today's addresses
  - Apartment renters 1716

# Tax Kinds

1. Schoß (vom Hause)
2. Schoß v. Hoffraum
3. Orgelgeld
4. Wächtergeld
5. Opfergeld
6. Flurhütergeld
7. Ladenzinß
8. Braugerechtigkeit
  
10. Schutzgeld

# The Process

- Handwritten tax files
  - Manually copying
- Excel tables
  - Import using COM Connect
    - Fancy version of VisualWorks 7.6
- Semantic Network
  - Representation using Seaside, Mondrian and SVG
- UI for the researcher



78 St. Einkommen, Preis je alter Zeit.

7.	3.
4.	4.
3.	7. 8
20.	3.
3.	4.
4.	2. 8
2.	2.
5.	6.
6.	4.
4.	1. 12.
3.	3.
4.	2. 4.
5.	1. 10 1/2
2.	2.

1.	12.
3.	3.
4.	4.
4.	4.
3.	3.

12. 20. 6 1/2

Summa Plebentromen

no 1/2 2/2 no 2 2

1. 17. 8

1. 7. 8 1. 7. 8

5. 10. 5. 10.

2. 7. 2 1/2 2. 7. 2 1/2

2. 2. 2. 2.

12. 20. 6 1/2 11. 5. 10 1/2

Rest Einahme Geld von Schloß

no 20 in Hallischer Viertel

59

1. 17. 8

8 Schiffer

Opul

Opul

Opul

Opul

Opul

Opul

Opul

Opul

Opul

Opul

Opul

Opul

Opul

Opul

Opul

Opul

Opul

Opul

Opul

Opul

Opul

Opul

Epistologe Francis Beck

Epistologe Francis Beck

Epistologe Francis Beck

Epistologe Francis Beck

Epistologe Francis Beck

1. 17. 8.

# Schoß-Register

Microsoft Excel - Schossregister.xls																																							
Frage hier eingeben																																							
Y204																																							
A	B	C	D	E	F	G	H	I	J	K	L	M	N	O	P	Q	R	S	T	U	V	W	X	Y	Z	AA	AB	AC	AD	AE	AF	AG	AH	AI	AJ	AK			
1	Nr	Viert.	Hauseigentümer			Jahr	Schoß (vom Hause)			Schoß v. Hoffraum				Orgrel			Wächter			Opfer			Flurhütergeld				Ladenzinß				Brau-								
2							Th	Gr	Pf	Pfge	Th	Gr	Pf	Pfge	Th	Gr	Pf	Pfge	Th	Gr	Pf	Pfge	Th	Gr	Pf	Pfge	Th	Gr	Pf	Pfge	Th	Gr	Pf	Pfge	Th	Gr			
52	50	Hall.	Georg	Stutz		1714	12			144,0				0,0	3	36,0	4	48,0	2	-	-	24,0																	
53	51	Hall.	Martin	Mürzburg		1714	12			144,0				0,0	3	36,0	4	48,0	4	-	-	48,0																	
54	52	Hall.	Hans	Reusch	Witwe	1714	12			144,0				0,0	3	36,0	4	48,0	4	-	-	48,0																	
55	53	Hall.	Andreas	Schröter		1714	12			144,0				0,0	3	36,0	4	48,0	4	-	-	48,0																	
56	54	Hall.	Jacob	Ruck		1714	10			120,0				0,0	3	36,0	4	48,0	4	-	-	48,0				7,5	7,5												
57	55	Hall.	Jacob	Schneider		1714	12			144,0				0,0	3	36,0	4	48,0	4	-	-	48,0																	
58	56	Hall.	Caspar	Fritsche		1714	1			288,0				0,0	3	36,0	4	48,0	4	8,0	-	-	56,0				7,5	7,5											
59	57	Hall.	Christian	Vierthaler	von Jah	1714	1	12		432,0				0,0	6	72,0	4	48,0				0,0																	
60	58	Hall.	Johann	Holtzmann		1714	1	12		432,0				0,0	6	72,0	4	48,0	6	-	-	72,0																	
61	59	Hall.	Gottfried	Fischer		1714	16			192,0				0,0	3	36,0	4	48,0	5	4,0	-	-	64,0				7,5	7,5											
62	60	Hall.	Tobias	Thüle		1714	12			144,0				0,0	3	36,0	4	48,0	4	8,0	-	-	56,0				7,5	7,5											
63	61	Hall.	Martin	Rath		1714	1	12		432,0				0,0	6	72,0	4	48,0	4	-	-	48,0																	
64	62	Hall.	Martin	Faulwaßer		1714	1	12		432,0				0,0	6	72,0	4	48,0	4	8,0	-	-	56,0																
65	63	Hall.	Christian	König		1714	12			144,0				0,0	3	36,0	4	48,0	4	-	-	48,0																	
66	64	Hall.	Andreas	Bönert		1714	12			144,0	1	12	432,0	0,0	6	72,0	4	48,0				0,0				3	9,0	45,0											
67	65	Hall.	August	Schreiber		1714	1	12		432,0				0,0	3	36,0	4	48,0	4	8,0	-	-	56,0				1	3,0	15,0										
68	66	Hall.	Johann Georg	Brandt	Advoc.	1714	1	18		504,0				0,0	6	72,0	4	48,0	6	-	-	72,0				3	9,0	45,0											
69	67	Hall.	Gottfried Joh. Christ	Laurentius		1714	1	12		432,0				0,0	6	72,0	4	48,0	5	4,0	-	-	64,0				1	3,0	15,0										
70	68	Hall.	Georg Lude	Findler	Secr.	1714	1	12		432,0				0,0	6	72,0	4	48,0	5	4,0	-	-	64,0																
71	69	Hall.	Christian Bernhardt	Kröger	Advoc.	1714	16			192,0				0,0	3	36,0	4	48,0				0,0				1	3,0	15,0											
72	70	Hall.	August	Behr		1714	2	15		756,0				0,0	6	72,0	4	48,0	4	-	-	48,0				2	6,0	30,0											
73	71	Hall.	Johann Friedrich	Herrmanns	Kämmerer	1714	1	22		552,0				0,0	6	72,0	4	48,0	4	-	-	48,0				2	6,0	30,0											
74	72	Hall.	Lebrecht Lungel.	Behr	Rathmann	1714	2	-		576,0				0,0	6	72,0	4	48,0	6	-	-	72,0																	
75	73	Hall.	Lebrecht Lungel.	Behr	Rathmann	1714	1	12		432,0				0,0	6	72,0	4	48,0				0,0																	
76	74	Hall.	Andreas Gottfried	Schulzes	Landr.	1714	16			192,0				0,0	3	36,0	4	48,0	2	8,0	-	-	32,0				1	3,0	15,0										
77	75	Hall.	Christian	Haupt		1714	12			144,0				0,0	3	36,0	4	48,0	4	8,0	-	-	56,0																
78	76	Hall.	Johann Georg	Behr		1714	12			144,0				0,0	3	36,0	4	48,0	5	4,0	-	-	64,0				7,5	7,5											
79	77	Hall.	Gottfried	Wöhrmann		1714	20			240,0				0,0	3	36,0	4	48,0	6	-	-	72,0				7,5	7,5												
80	78	Hall.	Joh. Christian	Friedrich		1714	12			144,0				0,0	3	36,0	4	48,0	4	8,0	-	-	56,0																
81	79	Hall.	Hans Georg	Thäder		1714	12			144,0				0,0	3	36,0	4	48,0				0,0				4	8,0	56,0											
82	80	Hall.	Johann Lebrecht	Schulz	vorm hä	1714	16			192,0				0,0	3	36,0	4	48,0	4	-	-	48,0				3	9,0	45,0											
83																																							
84																																							
85	1	Md	Wilhelm	Schulze		1714	20			240,0				0,0	3	36,0	4	48,0	4	-	-	48,0																	
86	2	Md	Georg	Kundt		1714	20			240,0				0,0	3	36,0	4	48,0	4	8,0	-	-	56,0																
87	3	Md	Michael	Grücherich		1714	1	12		432,0				0,0	6	72,0	4	48,0	5	4,0	-	-	64,0																
88	4	Md	Andreas	Kayser		1714	1	12		432,0				0,0	6	72,0	4	48,0	4	-	-	48,0																	
89	5	Md	Jacob	Große		1714	1	12		432,0				0,0	6	72,0	4	48,0	5	4,0	-	-	64,0																
90	6	Md	Andreas	Pützel		1714	1			288,0				0,0	3	36,0	4	48,0	6	-	-	72,0				2	6,0	30,0											
91	7	Md	August	Heinrich		1714	1	12		432,0				0,0	6	72,0	4	48,0	6	-	-	72,0																	
92	8	Md	Paul	Rosenhahns	Richter	1714	16			192,0				0,0	3	36,0	4	48,0	4	-	-	48,0																	
93	9	Md	Johann Christoph	Stöcker		1714	1	18		504,0				0,0	6	72,0	4	48,0	7	4,0	-	-	88,0																
94	10	Md	Martin	Müller		1714	1			288,0				0,0	3	36,0	4	48,0				0,0																	
95	11	Md	Elias	Döring		1714	12			144,0				0,0	3	36,0	4	48,0	4	-	-	48,0																	
96	12	Md	Joh. Völleuth	Schultze	Witwe	1714	14			168,0				0,0	3	36,0	4	48,0	2	-	-	24,0																	
97	13	Md	Heinrich	Geßard		1714	14			168,0				0,0	3	36,0	4	48,0	5	4,0	-	-	64,0																
98	14	Md	Hanß	Christel		1714	16			192,0				0,0	3	36,0	4	48,0	6	-	-	72,0																	
99	15	Md	Hans Christoph	Pötsch		1714	12			144,0				0,0	3	36,0	4	48,0	4	8,0	-	-	56,0																
100	16	Md	Christian	Hehrgeselle		1714	16			192,0				0,0	3	36,0	4	48,0	4	8,0	-	-	56,0				7,5	7,5											
101	16	Md	Joh. Gottfried	Sommer		1714	16			192,0				0,0	3	36,0	4	48,0	5	4,0	-	-	64,0																
102	17	Md	Kirchenvorste	d. luth. Gemeinde voi	Christian Neuma	1714	14			168,0				0,0	3	36,0	4	48,0	4	-	-	48,0																	
103	18	Md	Kirchenvorste	d. luth. Gemeinde voi	Tobias Bendorfs	1714	1	6		360,0				0,0	3	36,0	4	48,0	4	-	-	48,0																	
104	19	Md	Martin	Geiseler		1714	16			192,0				0,0	3	36,0	4	48,0	4	8,0	-																		



# GH-Bachnetz

Literaturverzeichnis  
Zurück zur Suche

Suchen:

## Haus

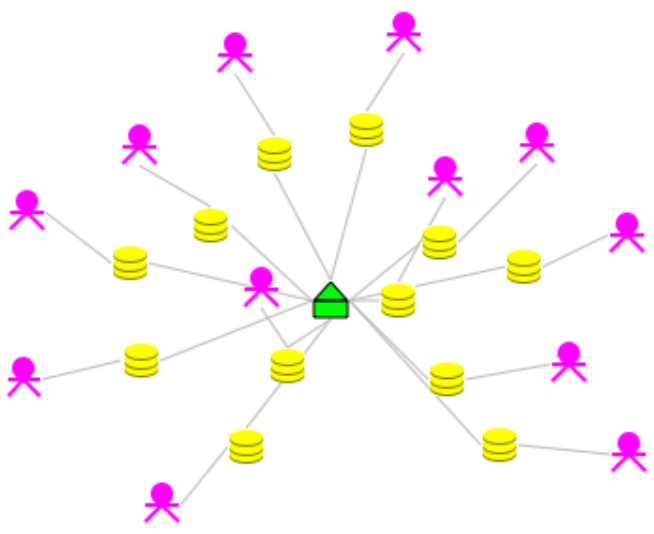

## Haus

Adresse: Wallstraße 17 (Hall. 10,301, 1819: 233) (→Google Maps)  
Viertel: Hallisches Viertel

Jahr	Name	Bezahlt	Summe	Solleink.	Eink.	Brunnen	Flurh.	Kehr	Opfer	Orgel	Orgrel
1741	August Gottlieb Weyders Ehefrau	Nein	1 T 3 Gr 7.5 Pf	-	-	-	7.5 Pf	4 Gr	4 Gr	3 Gr	-
1742	August Gottlieb Weyders Ehefrau ist noch in frei Jahre	Ja	1 T 3 Gr	-	-	-	-	4 Gr	4 Gr	3 Gr	-
1744	August Gottlieb Weyders Ehefrau	Nein	1 T 7 Gr 6.5 Pf	-	-	-	1 Gr 10.5 Pf	2 Gr	4 Gr 8 Pf	3 Gr	-
1745	August Gottlieb Weyders Ehefrau	Ja	1 T 7 Gr 6.5 Pf	-	-	-	1 Gr 10.5 Pf	2 Gr	4 Gr 8 Pf	3 Gr	-
1746	August Gottlieb Weyders	Nein	1 T 9 Gr 6.5 Pf	-	-	-	1 Gr 10.5 Pf	4 Gr	4 Gr 8 Pf	3 Gr	-
1747	August Gottlieb Weyder	Ja	1 T 7 Gr 6.5 Pf	-	-	-	1 Gr 10.5 Pf	2 Gr	4 Gr 8 Pf	3 Gr	-
1748	August Gottlieb Weyder	Ja	1 T 7 Gr 6.5 Pf	-	-	-	1 Gr 10.5 Pf	2 Gr	4 Gr 8 Pf	-	3 Gr
1749	August Gottlieb Weyder	Ja	1 T 7 Gr 6.5 Pf	-	-	-	1 Gr 10.5 Pf	2 Gr	4 Gr 8 Pf	3 Gr	-
1750	August Gottlieb	Nein	1 T 7 Gr 6.5	-	-	-	1 Gr 10.5 Pf	2 Gr	4 Gr 8 Pf	-	3 Gr

# Phase 4

- Central question: Where lived Johann Sebastian Bach?
  - Using GH-Bachnetz
  - Finding of answers



# Can we find the Bach house using letter addresses?

- Fully functional post system
  - Cöthen was connects
  - Postal system is known
  - Fees
    - A letter from Cöthen to Erfurt (120 miles) cost
      - 2 Groschen
      - about \$10



# Addresses

- Did not contain street or house descriptions
- Title and professions instead

5 10  
Jenen Hochwelen, Werten, Hochge,  
laysten und Hochweisen Herren  
Stadt-Schultheisen, Bürgermeister,  
Syndico und andern Rath's-Collegen.  
Maima insonderb hochzuachten Herren  
Patronis  
Franco. 2ge. in Lusth.

Lötter. d. 15. Martij  
ao. 1722.

verordneten Jener  
H. H. Hof. Rath.  
H. H. Hof. Rath.  
H. H. Hof. Rath.

# What kind of homes existed in Cöthen?

- In Cöthen
  - Some homes belonged to the City of Cöthen
  - The other homes („auf dem Ampte“) were owned by the Prince
- Taxes were due for the homes in the City
  - To be paid by home owners
  - Complete tax list is archived
- Homes of the Prince were rented
  - So called “Lehnurkunden” are archived in State Central Archive in Dessau

# Is Bach's name in the Tax Lists?

- In the contrary to other musicians Johann Sebastian Bach was neither
  - A home owner in the City
  - A home renter from the Prince
- Johann Sebastian Bach lived as renter in Cöthen in a house of someone else
  - Called „Hausgenosse“ those days
  - Like Bach's predecessor Augustin Stricker



# Homes in Cöthen?

- City view of Cöthen 1650

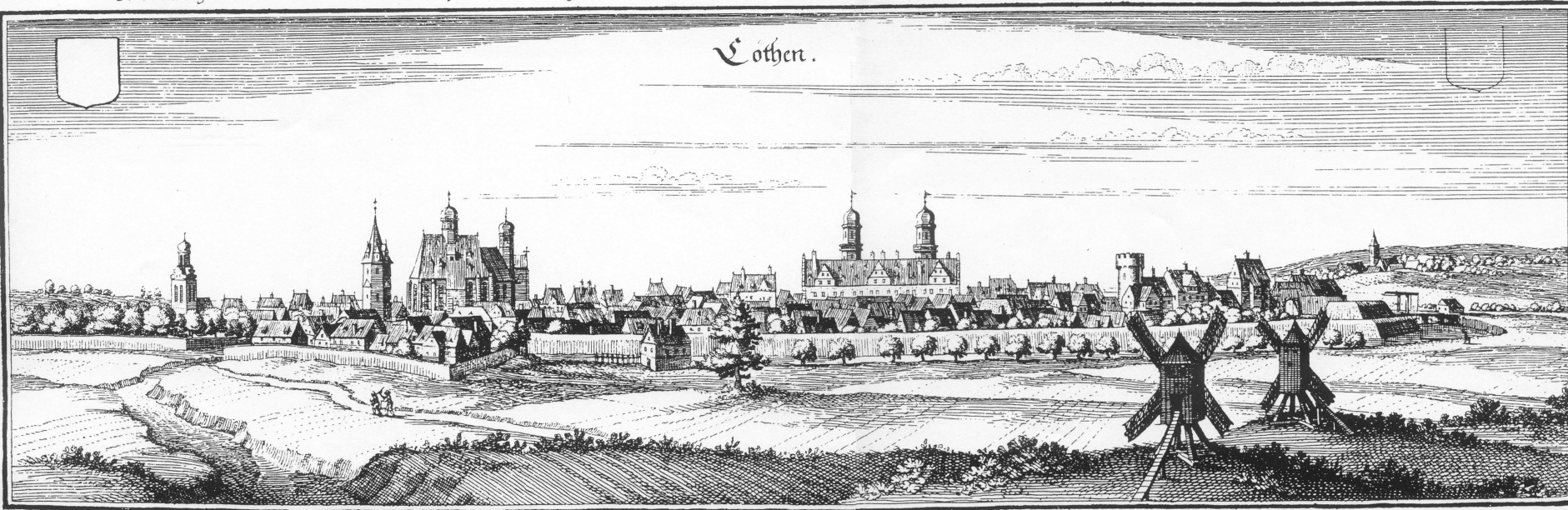



# Oldest City Map 1730

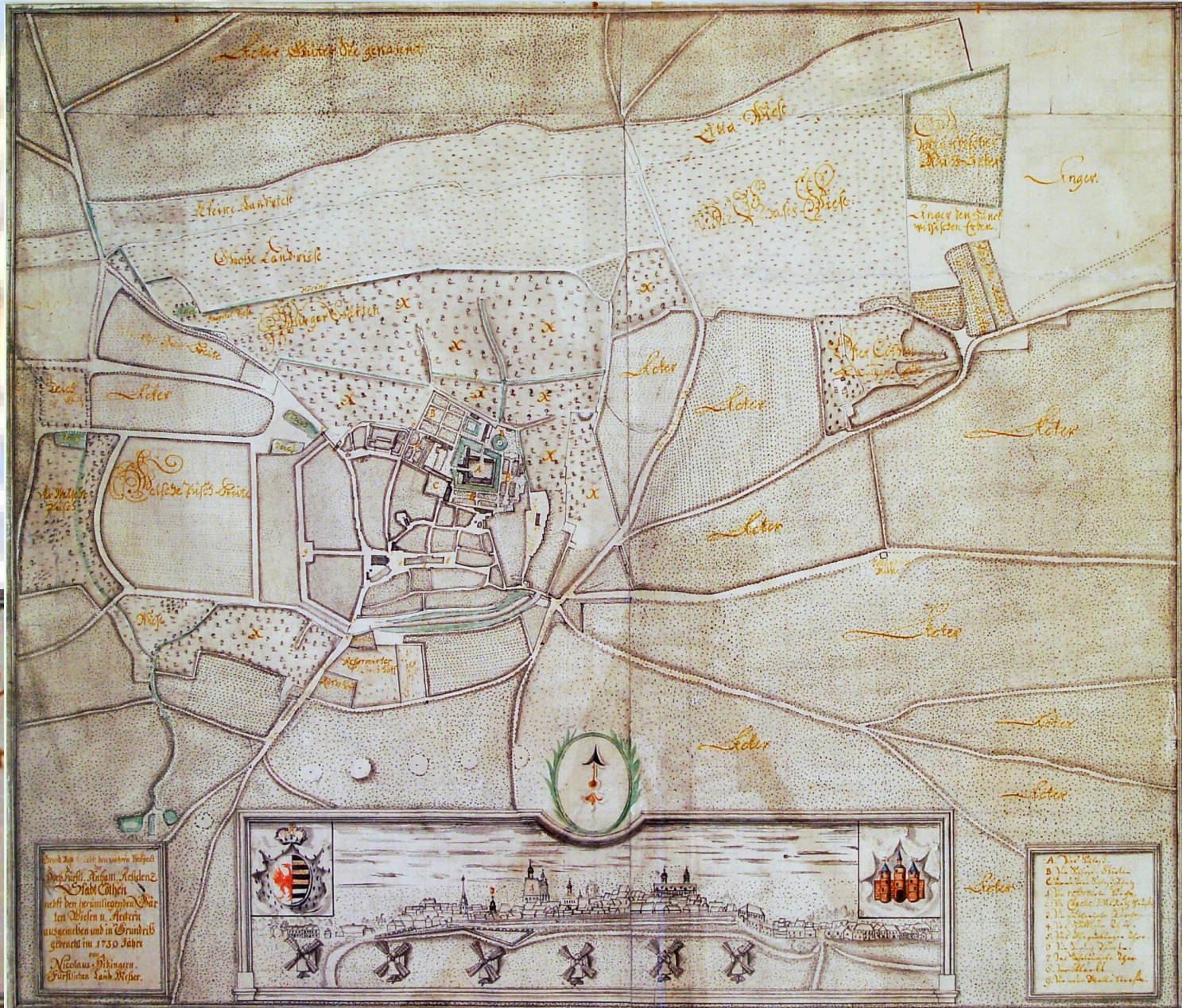

Grund-Plan u. d. wahren Topog. d. Hochfürstl. Anhalt. Residenz Stadt Cothen nebst den herumliegenden Bärten Wiesen u. Aedern ausgemessen und in Grundriß gebracht im 1730 Jahre  
 von  
 Nicolaus Nihingern, Fürstlichen Land-Meßer.

Grund-Plan u. d. wahren Topog. d. Hochfürstl. Anhalt. Residenz Stadt Cothen nebst den herumliegenden Bärten Wiesen u. Aedern ausgemessen und in Grundriß gebracht im 1730 Jahre  
 von  
 Nicolaus Nihingern, Fürstlichen Land-Meßer.

A. Die Kirche  
 B. Die Wache  
 C. Die Stadt  
 D. Die Wälle  
 E. Die Wiesen  
 F. Die Aedern  
 G. Die Bärten  
 H. Die Meßer  
 I. Die Stadtmauer  
 K. Die Stadtmauer  
 L. Die Stadtmauer  
 M. Die Stadtmauer  
 N. Die Stadtmauer  
 O. Die Stadtmauer  
 P. Die Stadtmauer  
 Q. Die Stadtmauer  
 R. Die Stadtmauer  
 S. Die Stadtmauer  
 T. Die Stadtmauer  
 U. Die Stadtmauer  
 V. Die Stadtmauer  
 W. Die Stadtmauer  
 X. Die Stadtmauer  
 Y. Die Stadtmauer  
 Z. Die Stadtmauer



# City Center 1730

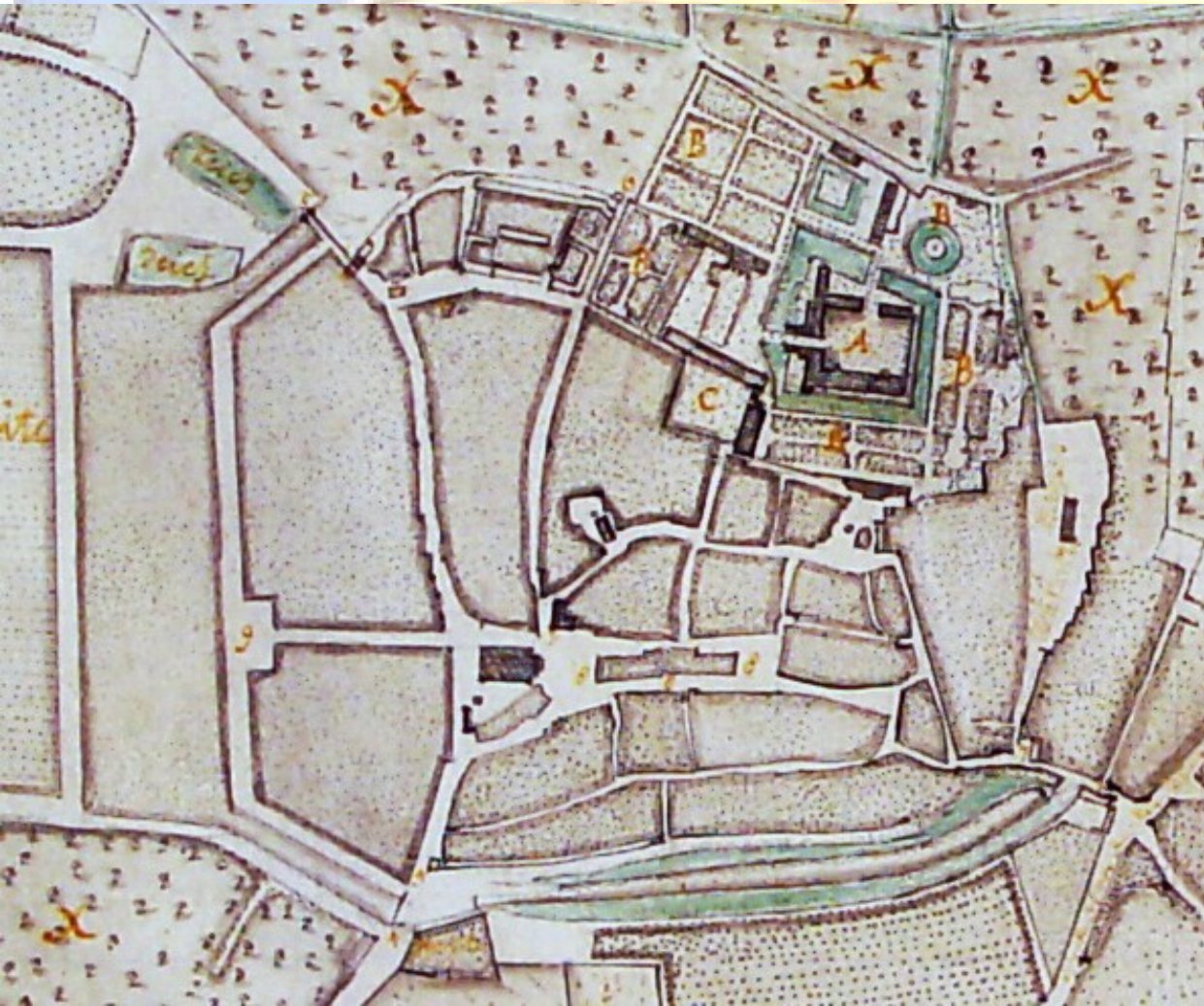

- A. Das Schloss.
- B. Von Schloss - Garten.
- C. Von dem Schloss - Platz.
- A. Von reformirter Kirche.
- E. Von Capelle. D. Das Holz - Haus.
- B. Von Lutherischer Kirche.
4. Das gallysche Haus.
5. Das Magistrate - Haus.
- O. Von dem Hof - Haus.
7. Das Befehlshaber - Haus.
8. Von Markt.
9. Von dem Markt - Hof.



# Cöthen Recently



Sponsored by European Union, State Saxony-Anhalt, County Cöthen, County Anhalt-Bitterfeld and City of Cöthen (Anhalt)



# Old and New





- 68
- A. Das Schloß.
  - B. Luther's Kirche.
  - C. Reform's Kirche.
  - D. Mühle unter der Erde.
  - E. Bähr Thor.
  - F. Hallische Thor.
  - G. Magdebf. Thor.
  - H. Schloß Thor.
  - I. Hirsch Thor.
  - K. Phasanerie.
  - L. Die sieben Brün.
  - M. Der Pest Baum.



3

# COETHEN

Aufgenömen in May 1778.

von  
F. C. von Schöuroth.

Königl. Preuß. Lieut. Regt. v. Erb Prinz.



100 200 300 400 500 600 700 800 900 1000 Schritte



Aut 13

31 x 23

IV 72



# City Center Cöthen 1778

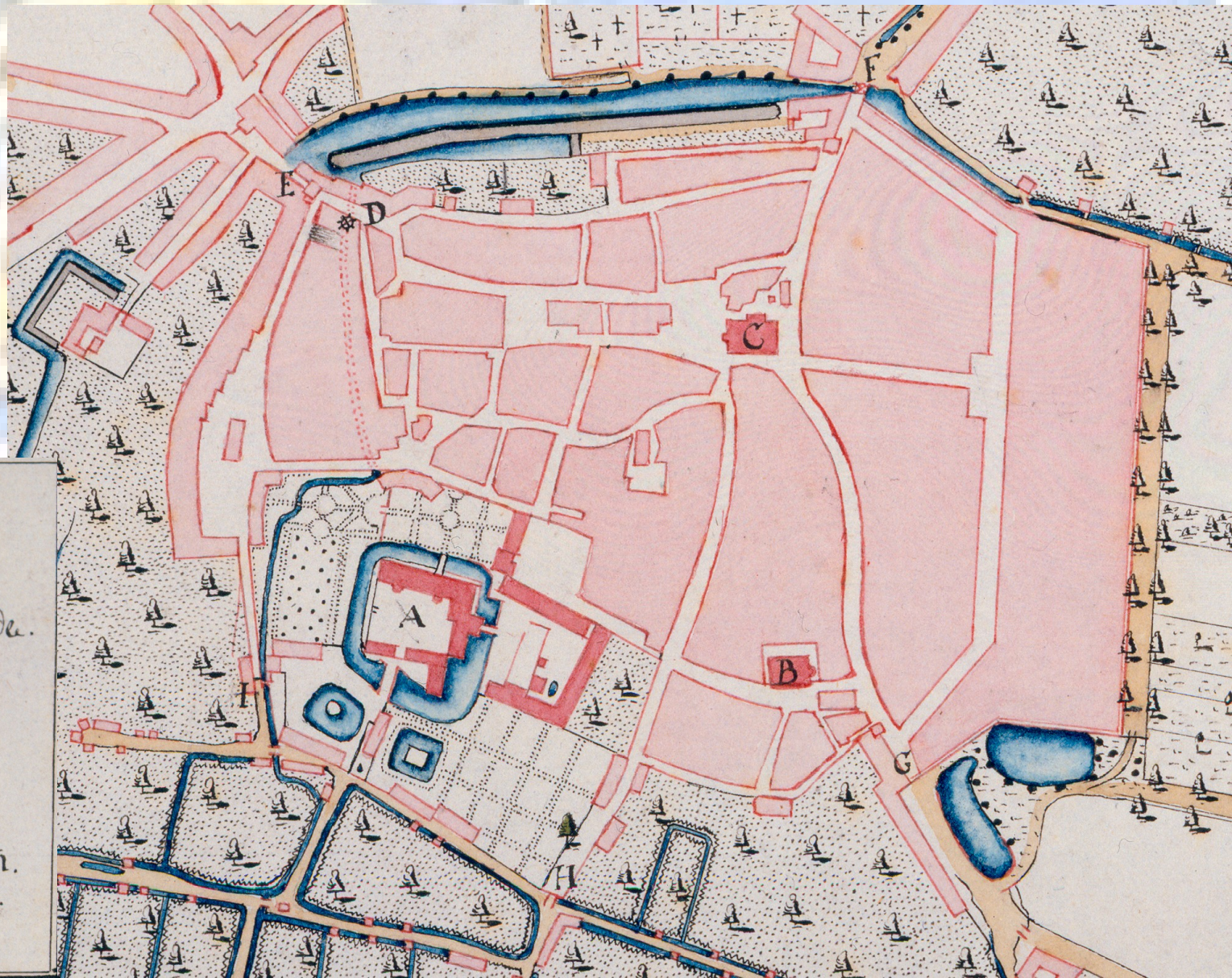

- 08
- A. Das Schloß.
  - B. Luther's Kirche.
  - C. Reformirte Kirche.
  - D. Mühle unter der Erde.
  - E. Bähr Thor.
  - F. Hallische Thor.
  - G. Magdeburg Thor.
  - H. Schloß Thor.
  - I. Hirsch Thor.
  - K. Phasanerie.
  - L. Die sieben Brunn.
  - M. Der Pest Baum.



# Old City Wall

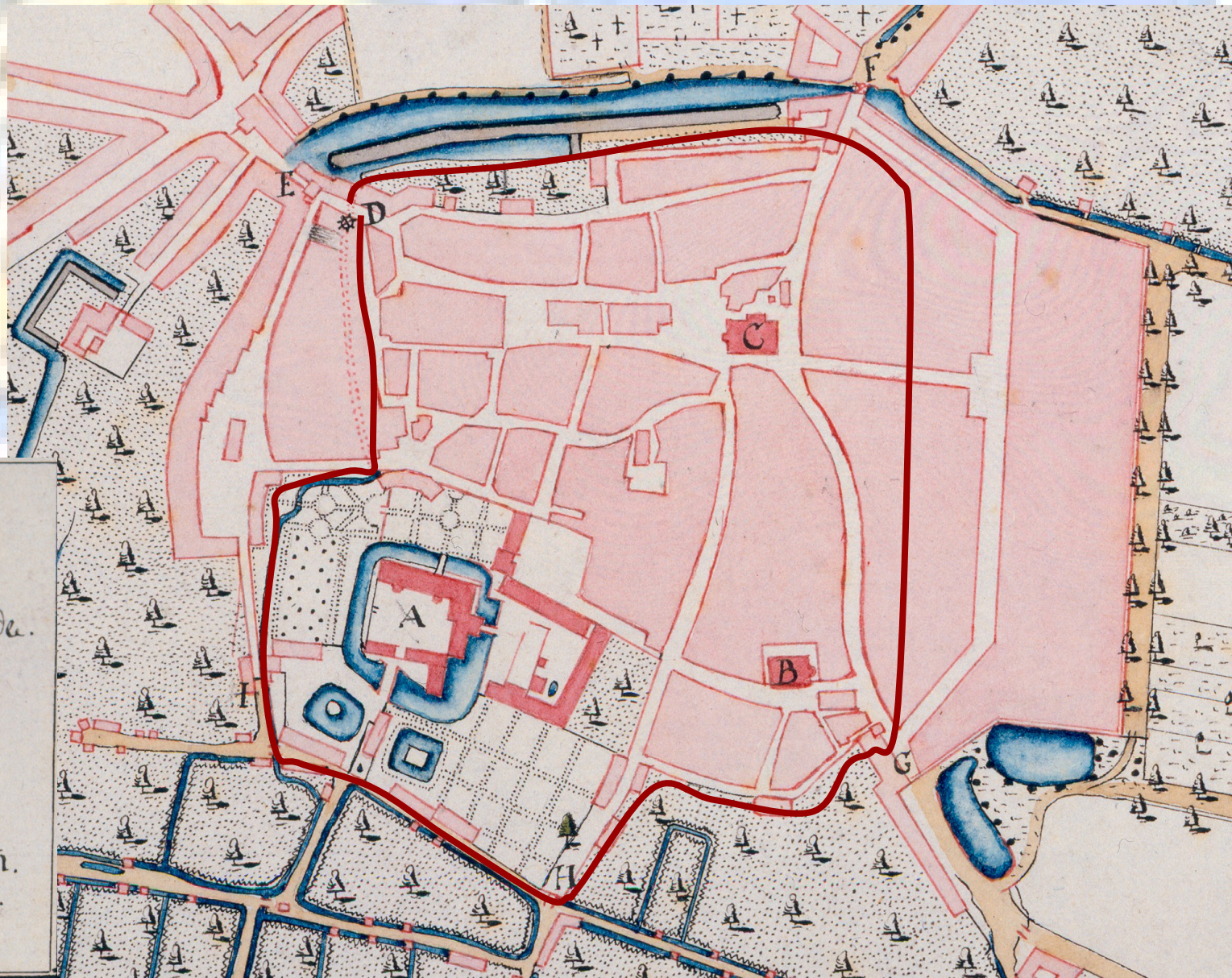

- 08
- A. Das Schloß.
  - B. Luther's Kirche.
  - C. Reform's Kirche.
  - D. Mühle unter der Erde.
  - E. Bähr Thor.
  - F. Hallische Thor.
  - G. Magdebb Thor.
  - H. Schloß Thor.
  - I. Hirsch Thor.
  - K. Phasanerie.
  - L. Die sieben Brün.
  - M. Der Pest Baum.



# Known Facts about the Home of Johann Sebastian Bach

- It is known
  - Johann Sebastian Bach had spacious home
    - Big family
    - External students lived with him
  - Hofkapelle Cöthen did their exercises Bach's home



# Potential Bach Homes

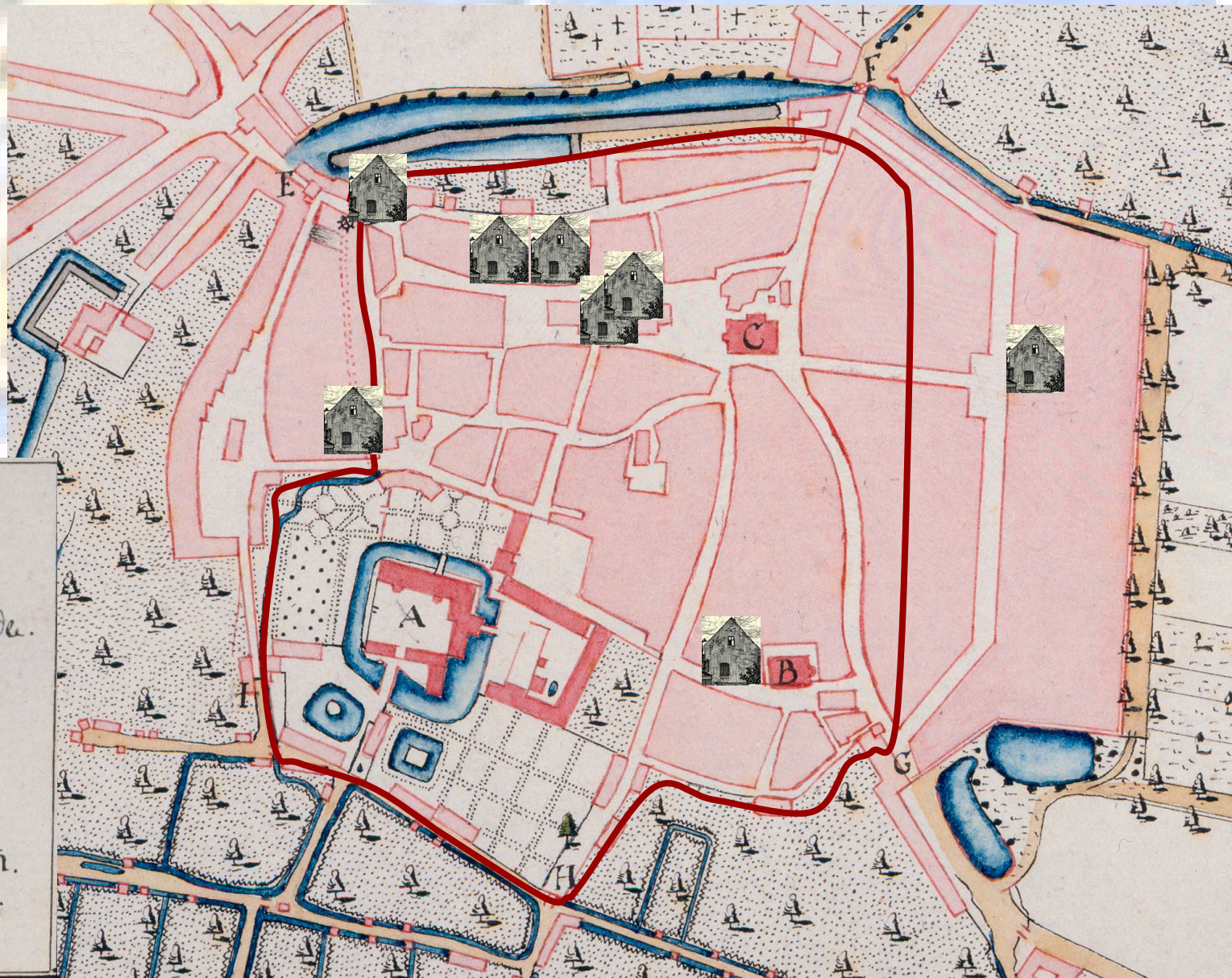

- 08
- A. Das Schloß.
  - B. Luther's Kirche.
  - C. Reform's Kirche.
  - D. Mühle unter der Erde.
  - E. Bähr Thor.
  - F. Hallische Thor.
  - G. Magdebb Thor.
  - H. Schloß Thor.
  - I. Hirsch Thor.
  - K. Phasanerie.
  - L. Die sieben Brün.
  - M. Der Pest Baum.



# Burgstraße 11

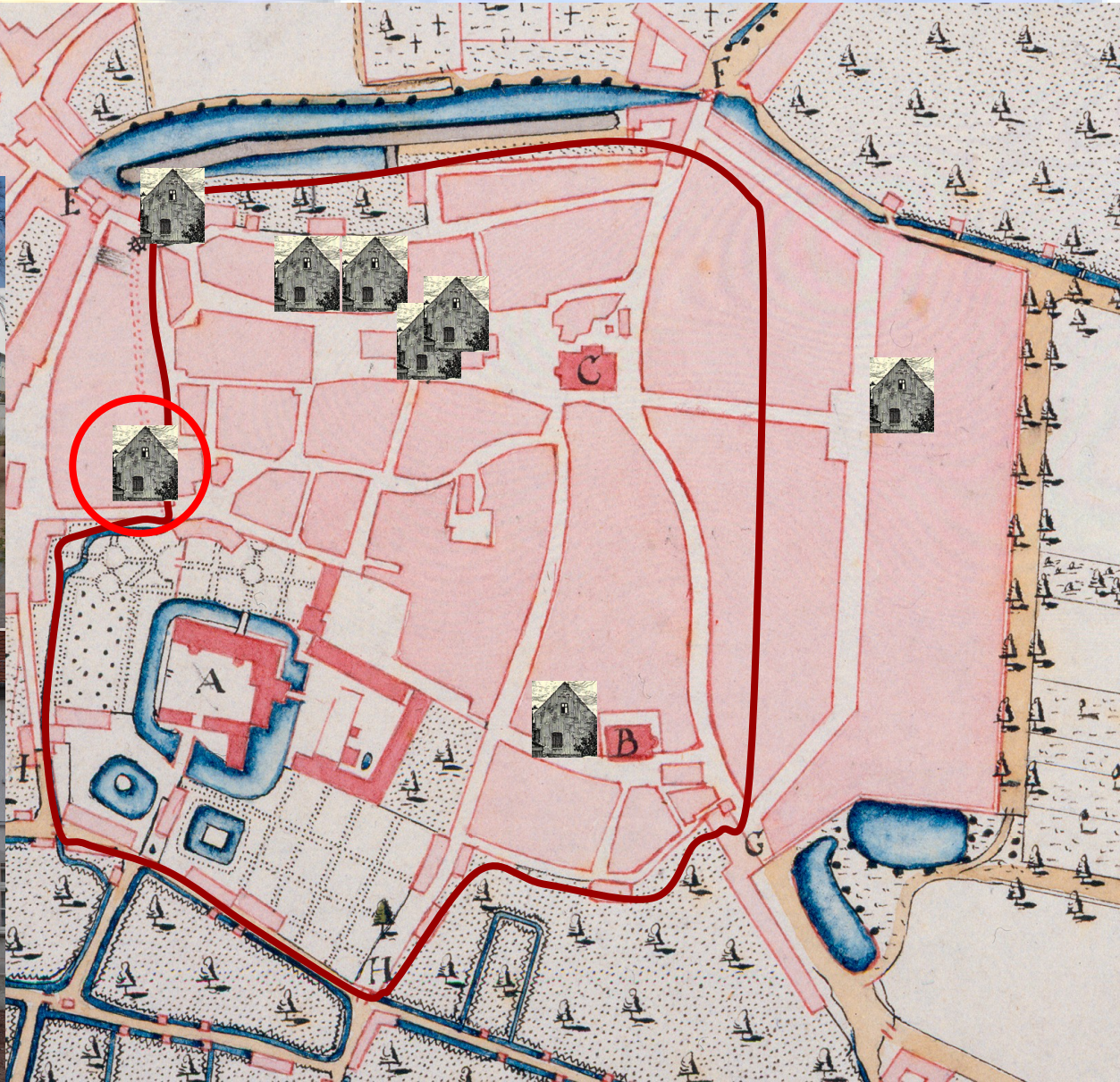



# Schalaunische Str. 29

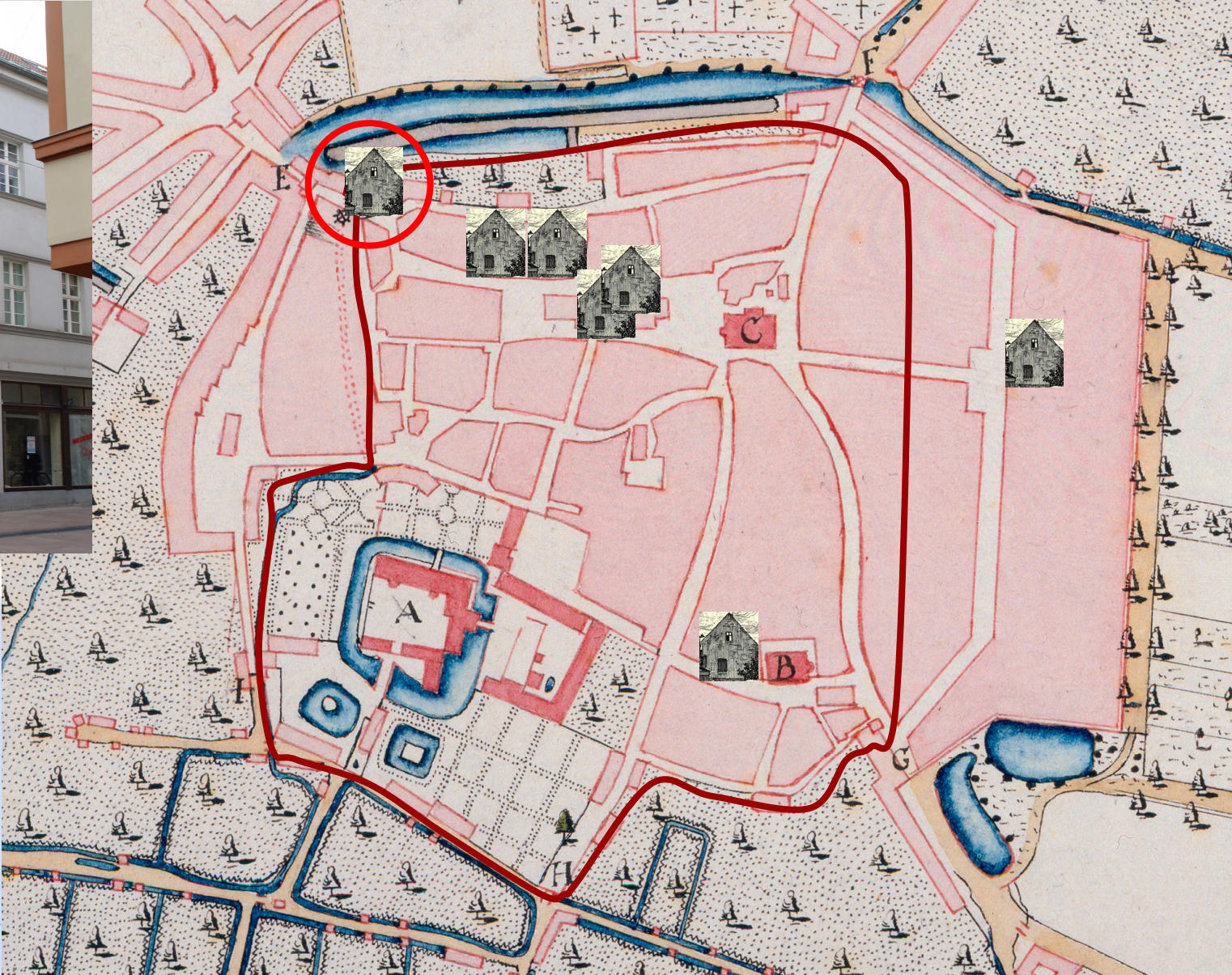



# Bach and the Name Ehrhard

6 Jof. Bernold's Wth Jun. Brandenburgers Wth, Unger, Bernhart  
Jun Schönlauke Nicol Dilling; <sup>657</sup> Brendel Wagner, Ezinger,  
Ludw Ameling Paul Ull, <sup>657</sup> Fochmann, Franke, Döbler, etc  
Nellie. Oetzall, Jun Junthel, Ehrhard, Walke, Keiseler,  
Bach

- In a list of 1855 the name Bach occurs
  - The line above describes Holzmarkt 12



# Holzmarkt 12

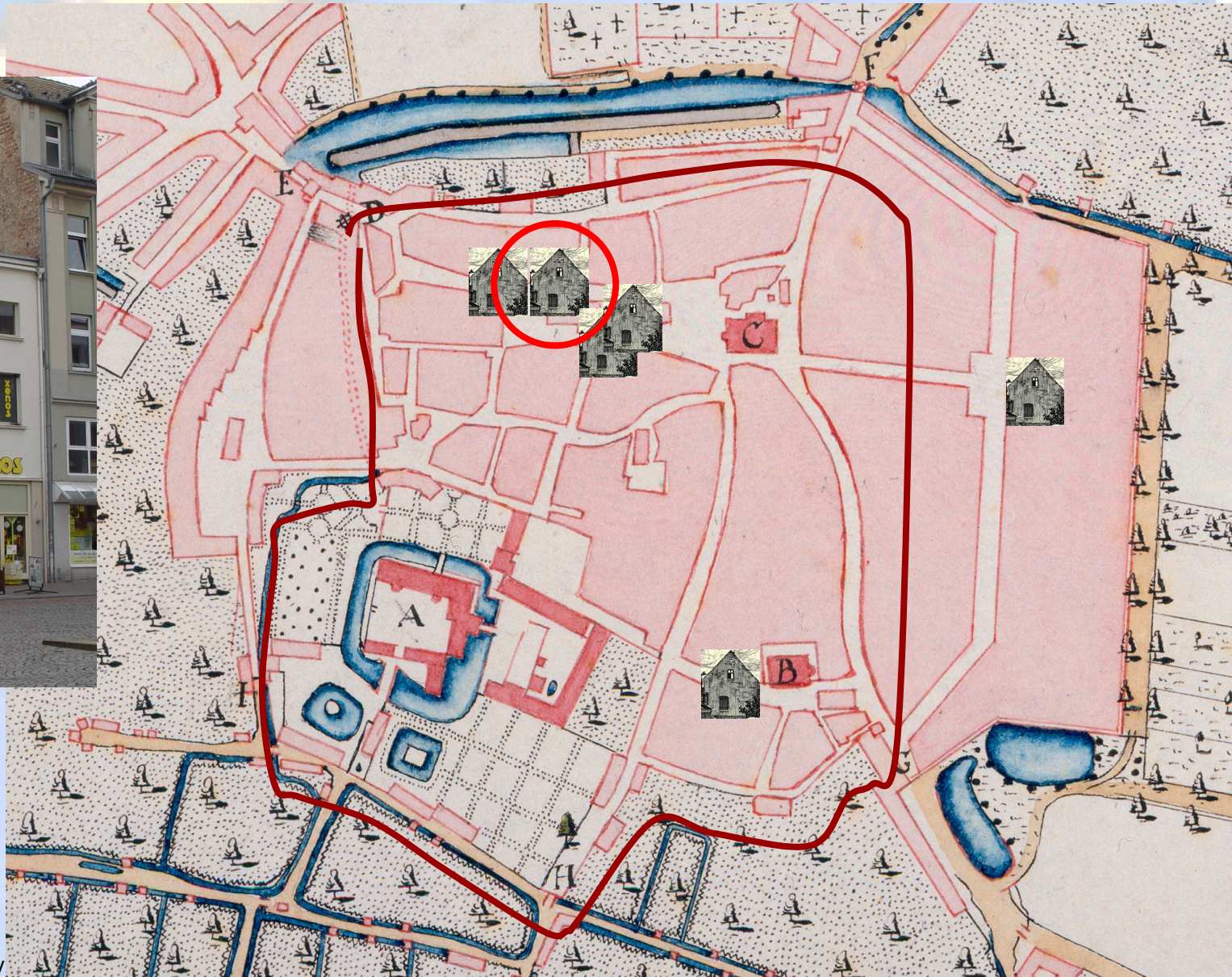



# Marktstraße 11

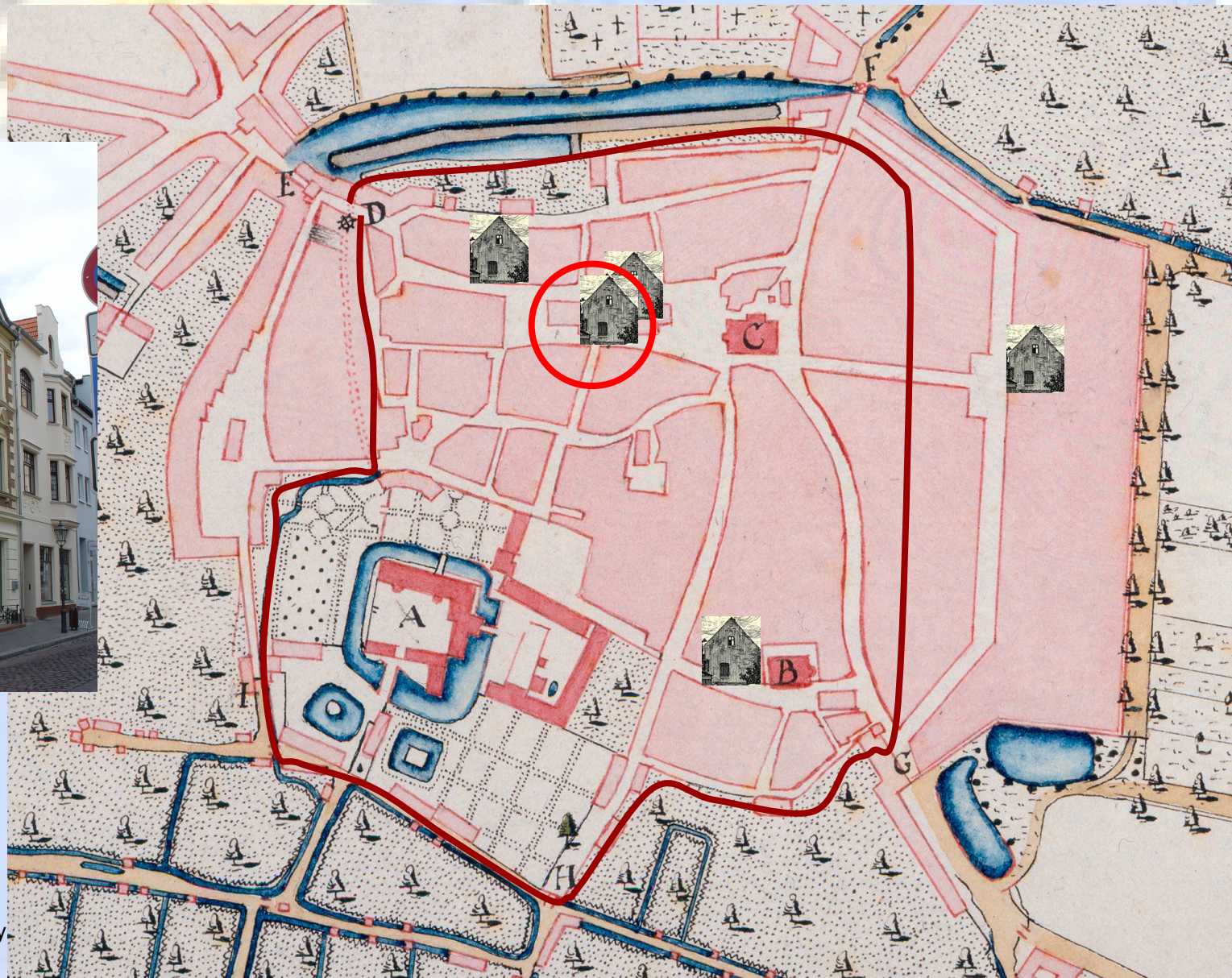



# Stiftsstraße 11





# Bibliometric Analysis

- There is a single source which tells that Frau Oberamtman Schultze has a connection to Bach
  - Hartung 1900
- Bethge and Götze 1923 merge a statement of Bunge with the statement of Hartung:
  - „Two houses from the Schallaunisch Tour towards the city on the left hand side a Frau Oberamtman Schultze shall have lived, at whom Bach was a renter.“
- 1959 König picks up the statement of Hartung after finding a document mentioning the name of Frau Oberamtman Schultze:
  - He expresses his surprise: „It is astonishing, that a certain name in this context has be passed down until today.“

# Hartung's Source

- Hartung knew the document
  - C17 Nr. 141 „Acta betr. die von der Oberamtmännin Schulze zu Cöthen beanspruchte Entschädigung von jährlich 20 Reichstaler für die Zeit, wo die lutherische Gemeinde daselbst vor Erbauung ihrer Kirche in der ersteren väterlichem Hause ihren Gottesdienst gehalten und was deshalb ergangen“
- Hartung coded a guess
- So no reason to be surprised



# The three Homes of Johann Andreas Lautsch

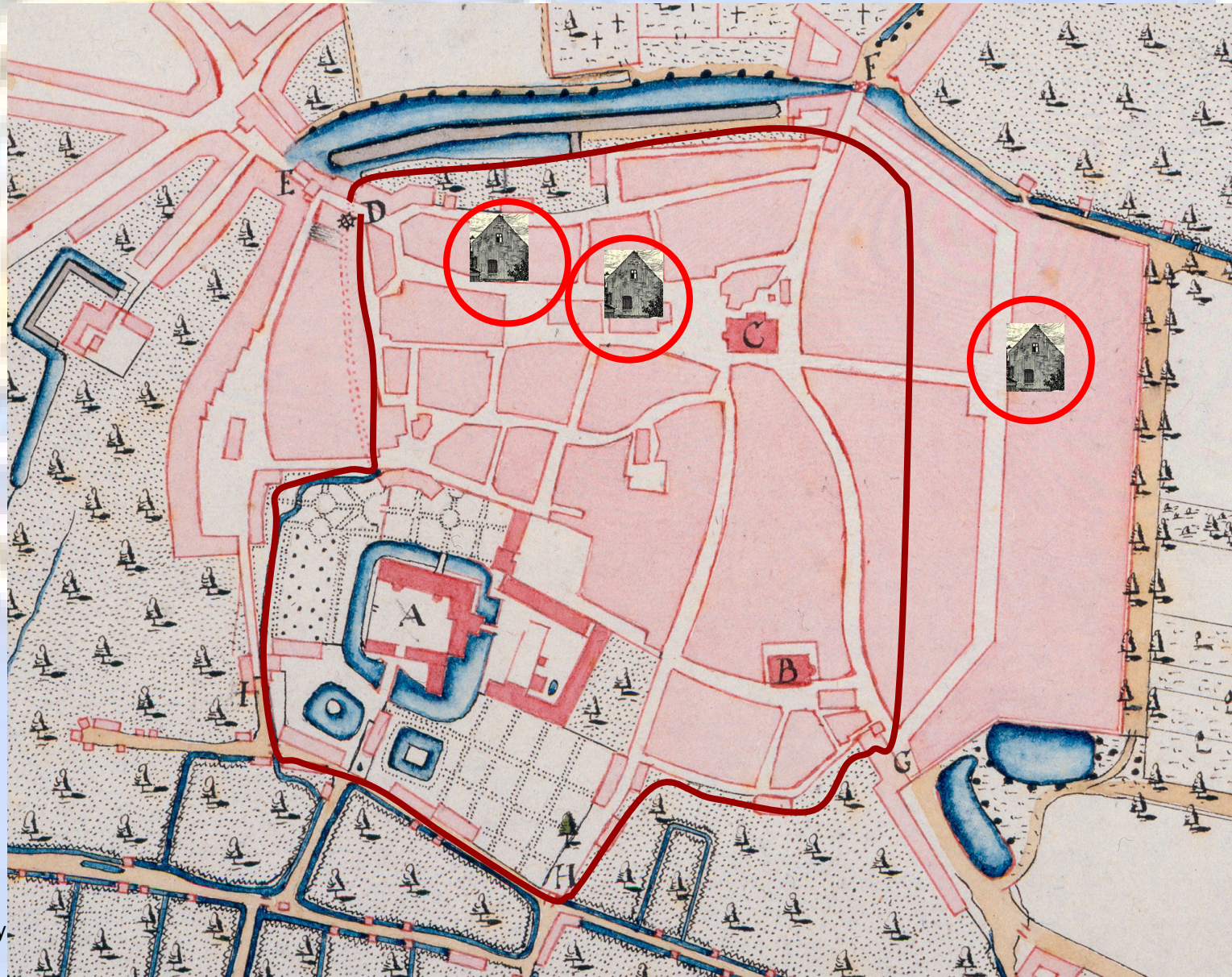



# Buttermarkt 3

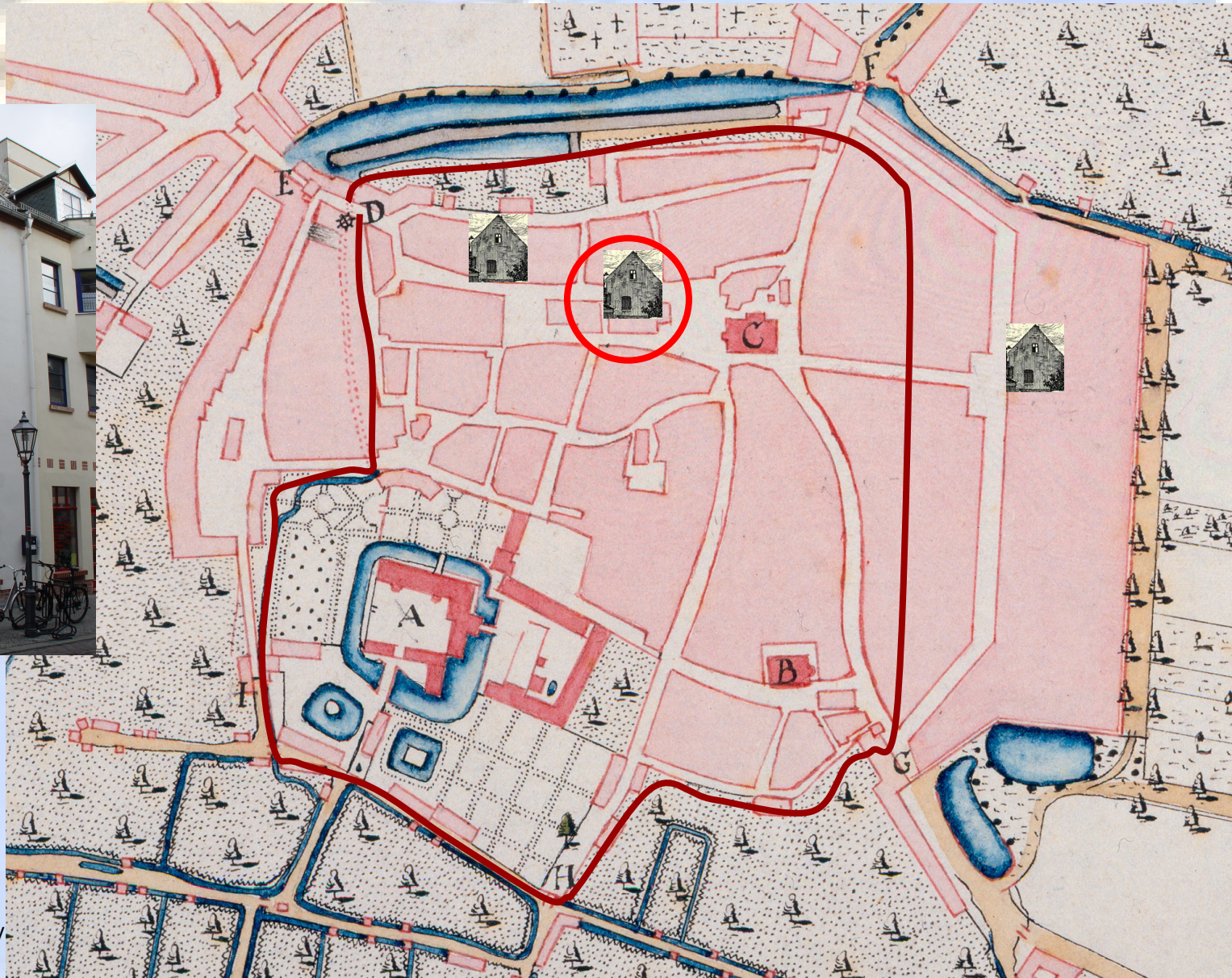

Sponsored by.



# Schalaunische Str. 44





# Schalaunische Str. 44

- Until 1899 Schalaunische Str. 42
- Nr. 88 in houses list of Napoleon era
- Owners
  - Krämer Johann Andreas Lautsch from 1710 (or earlier) until 1741
  - Post master Johann Heinrich Lautsch (1742-1761)
  - Post master Johann Heinrich (Friedrich) Lautsch Inheritors (1762-1782)
  - Johann Gottfried Schreiber (from 1783)



# One of the Largest Homes of the City of Cöthen

- 2 Taler 9 Groschen Schoss  
(corresponding to \$265 real property tax)
- Of 451 homes only six homes had a  
higher tax

1884

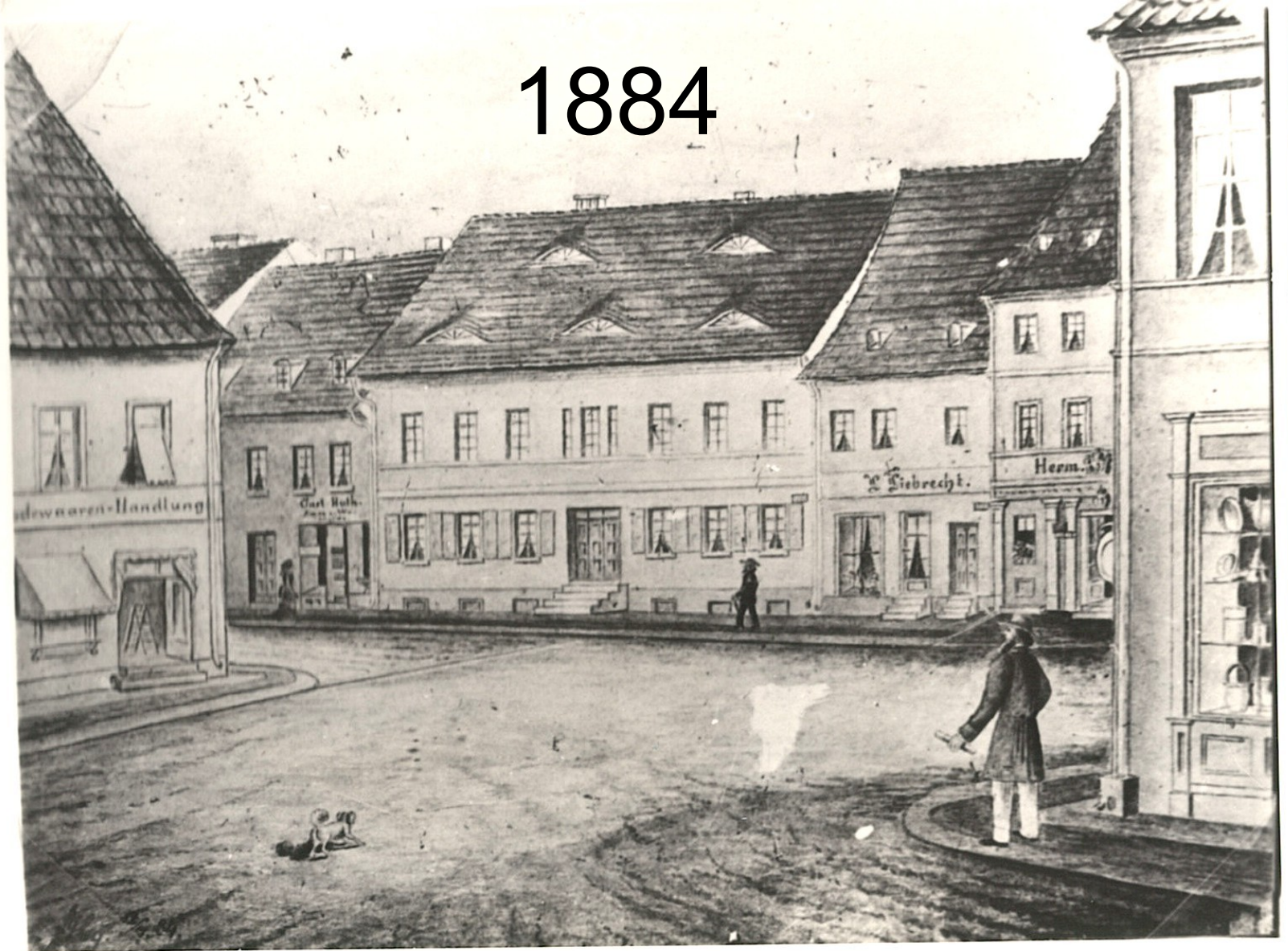

a. Modewaren von Mollheim, Abelman; b. Carl Huth, c. Gutshaus Schreiber;  
d. Putzmacherin Liebrecht; e. Zigarrengeschäft Braune; f. Basar Frank;  
c,d,e: jetzt Kontaktkaufhaus - Konsum



2008





# Water Mill “Bladdermühle”

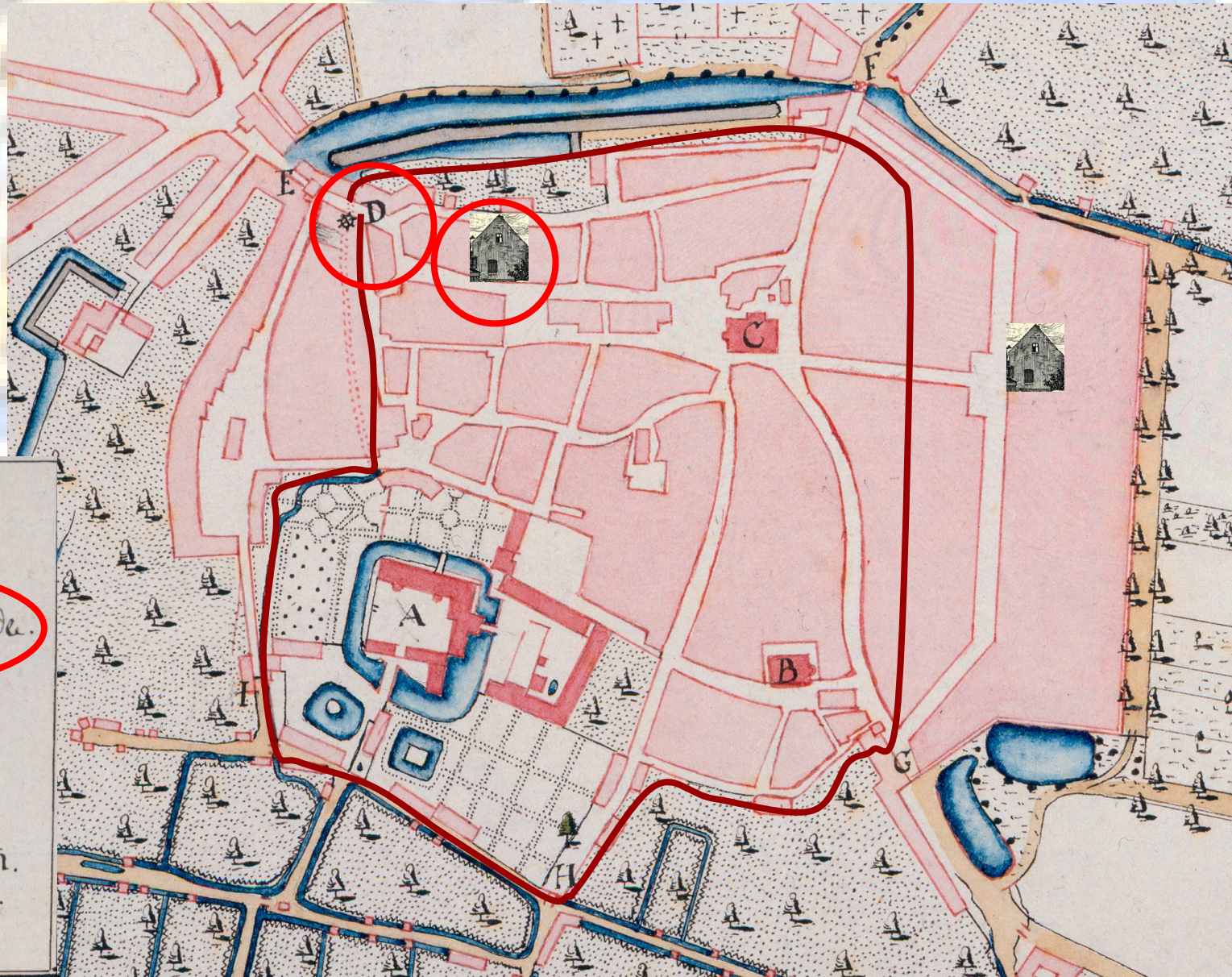

- 08
- A. Das Schloß.
  - B. Lutherg. Kirche.
  - C. Reformg. Kirche.
  - D. Mühle unter der Erde.
  - E. Bähr Thor.
  - F. Hallische Thor.
  - G. Magdebb. Thor.
  - H. Schloß Thor.
  - I. Hirsch Thor.
  - K. Phasanerie.
  - L. Die sieben Brün.
  - M. Der Pest Baum.



# The Rattling Mill

- Bunge wrote 1905:
  - Bach complained that the rattling mill disturbed him
- Schalaunische Straße 44 is close to Bladdermühle

# Schalaunische Straße 44

- Augustin Stricker exercised with Cöthen Hofkapelle here
- Sebastian Bach exercised with Cöthen Hofkapelle here
- Johann Sebastian Bach lived here
  - initially



# Wallstraße 25/26

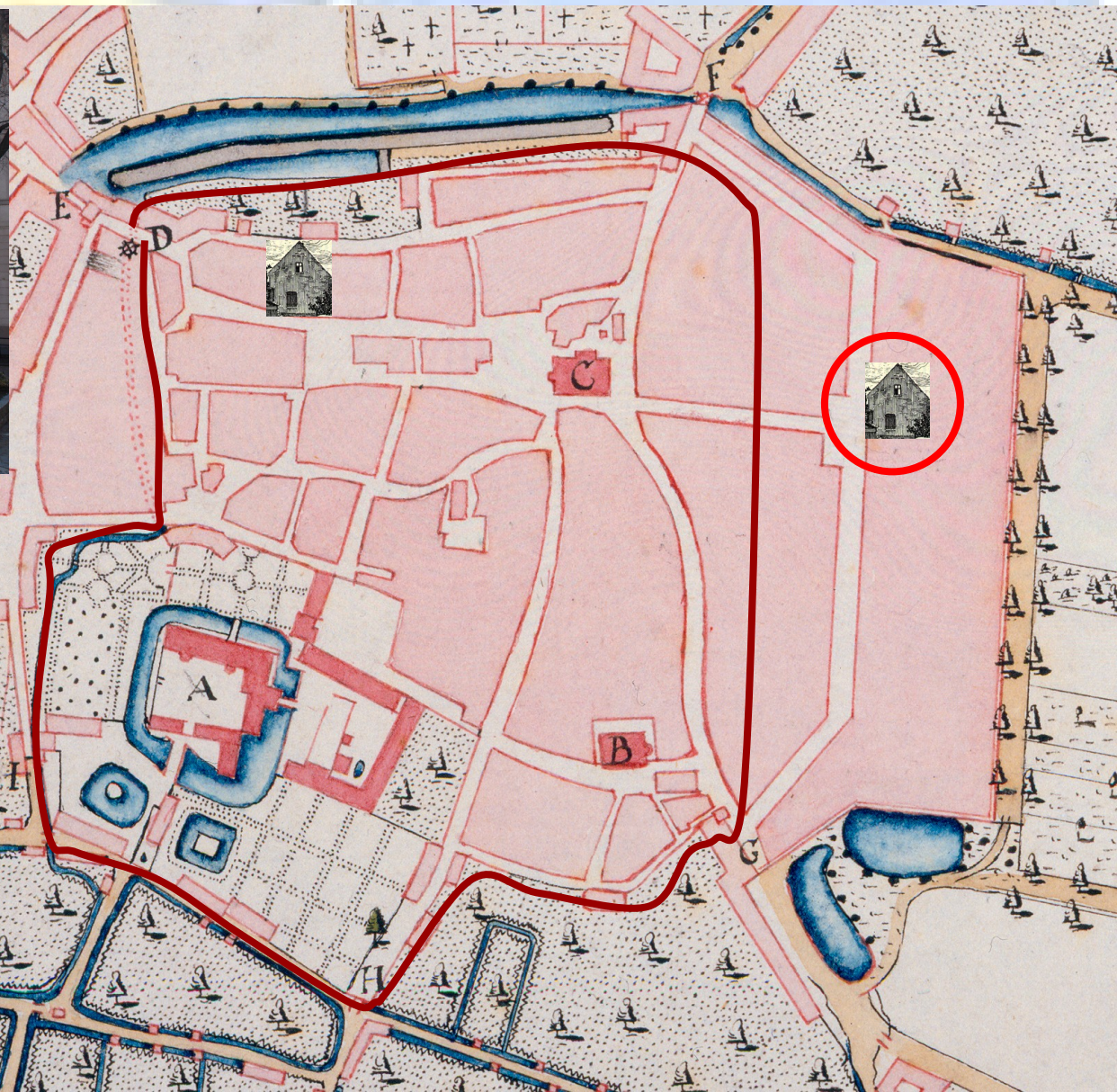



# Wallstraße 25/26 in the Literature

- Haetge and Harksen write 1943:
  - „Nr. 26 (so called Bach House). Erected 1712. Here lived Stricker, predecessor of Joh. Seb. Bach, and he also 1717-1723.“
- Schubart refers to them 1954.
- König 1957 Schubart criticizes Schubart
  - 1713 Johann Andreas Lautsch loaned land parcel Wallstraße 25/26 as garden
  - 1729 Hofrat Pfau lived here as renter
  - Thus the building has been constructed in 1729.
  - „Wallstraße Nr. 25 drops out as Bach House irrevocably.“



# Wallstraße before 1719

- Connecting way outside the city walls between Hallesch and Magdeburger suburbs
- Gold and silver fiber manufactory
  - „Fabrique“
- Gardens of wealthy citizens

# Cöthen's Baroque Quarter

- 27 February 1719
- Prince Leopold of Anhalt-Cöthen took the decision
  - Wallstraße and Schulstraße and today's Bachplatz shall be built up as city extension
  - A new city wall shall be erected around
  - Property shall be tax exempt as long as not all land parcels have houses
    - Source: Acta, betr. was der Anbauung der neuen Stadt zu Cöthen ergangen, Landeshauptarchiv Sachsen-Anhalt Dessau (LHASA DE), Abteilung Cöthen, C 2a II Nr. 99, Fol. 175 rück



# Baroque Quarter Plan from 1719

- Wallstraße
  - straight
  - two kinks
- Schulstraße
  - straight
- Typical for Baroque city arrangements

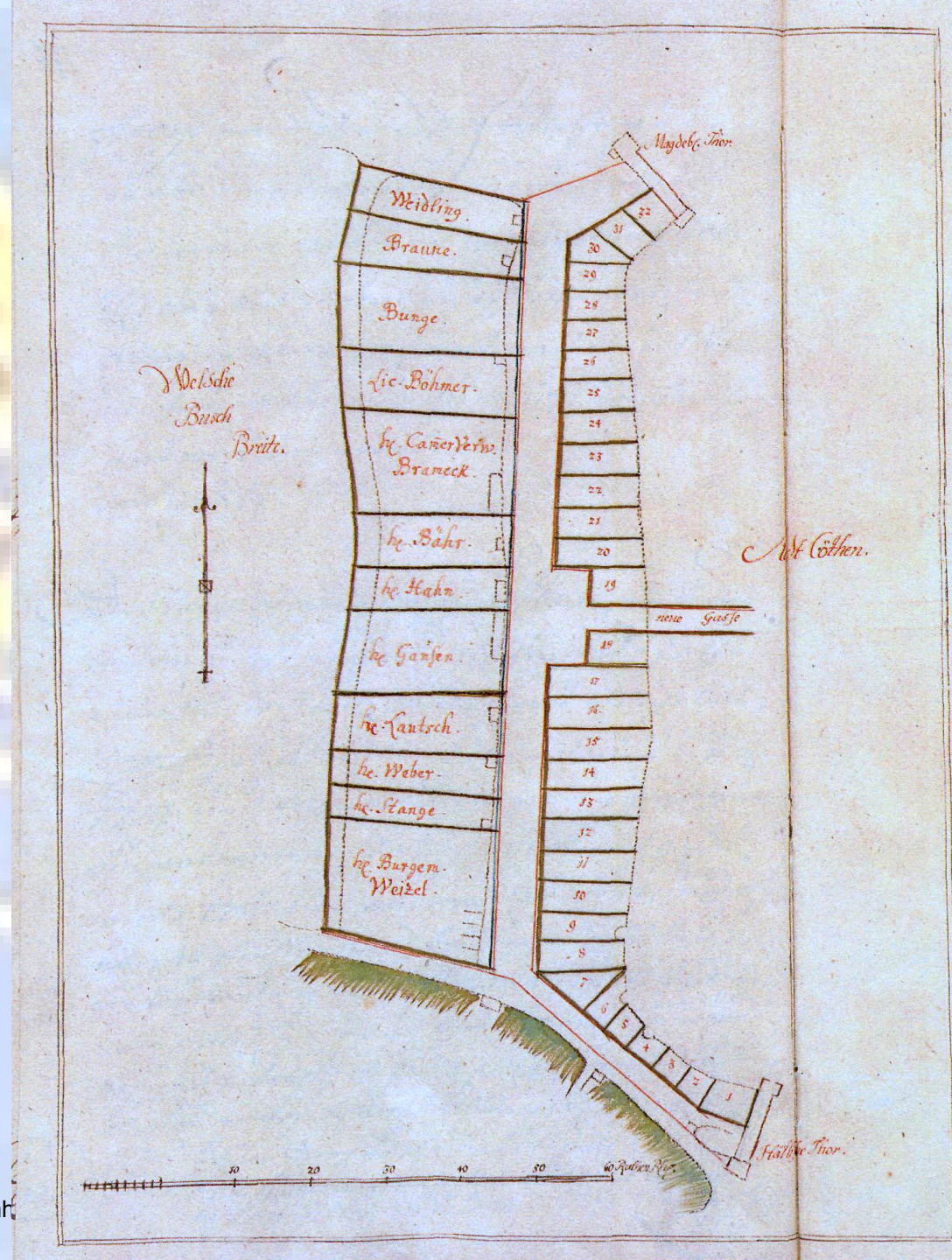

# Taxation starting in 1730

- Leopold's successor prince August Ludwig
  - Changed the tax exemption rule
    - New buildings are only three years tax exempt



# Baroque Quarter 1730

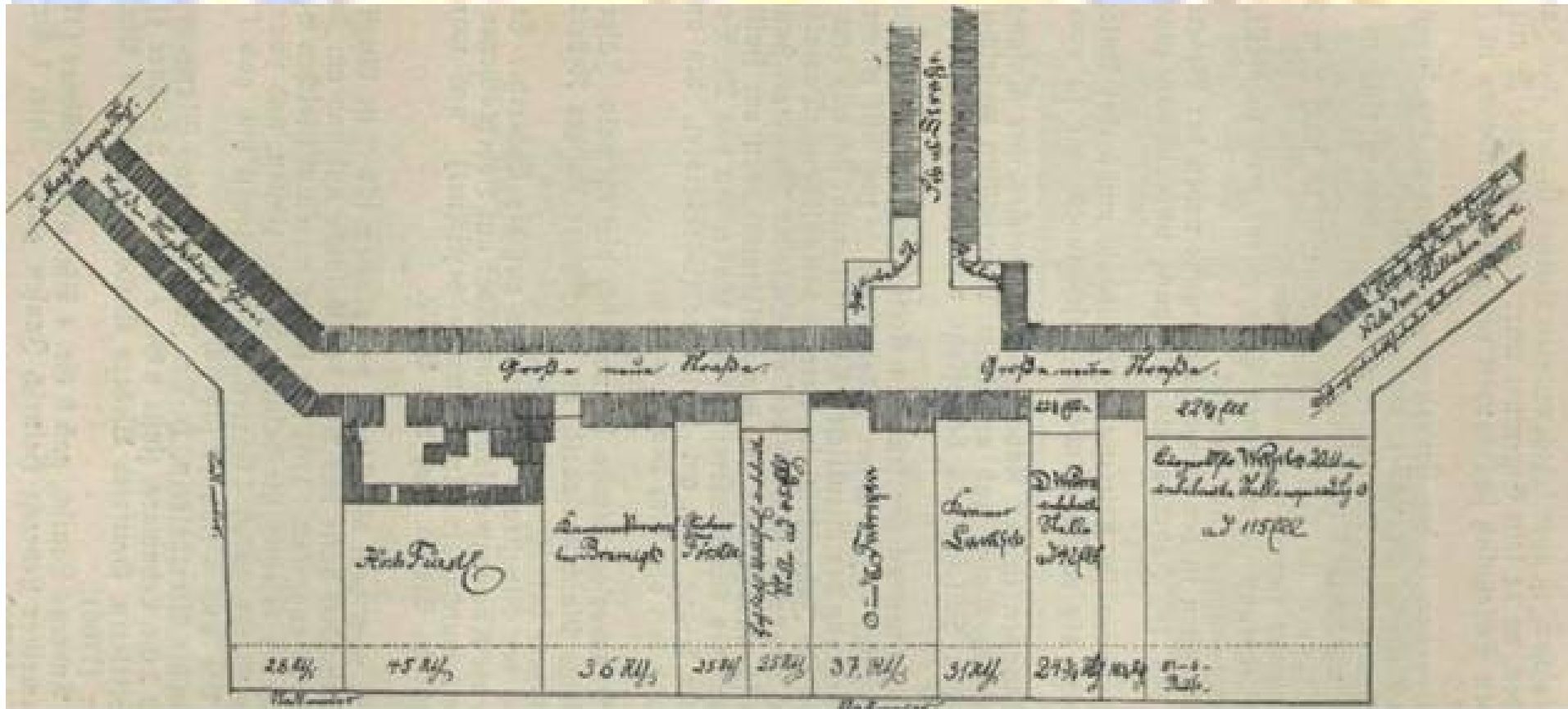

# When where the homes built in Baroque Quarter?

- Semantic network answered the question
  - Example: Schulstraße 16



# GH-Bachnetz

Suchen:

Literaturverzeichnis  
Zurück zu: Haus

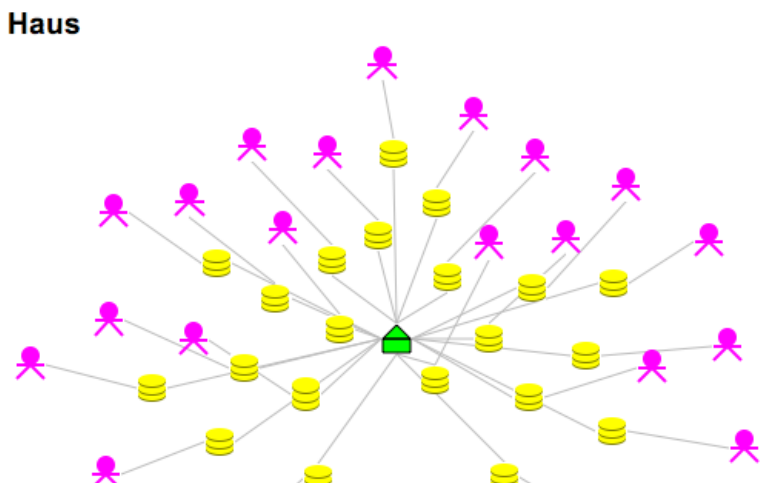

## Haus

Adresse Schulstraße 16 (Hall. 10,34, 1819: 292) (→Google Maps)  
Viertel Hallisches Viertel

Jahr	Name	Bezahlt	Summe	Solleink.	Eink.	Brunnen	Kehr	Opfer	Orgel	Orgrel	Schoß (vom Hause)	Wächter
1730	Vallrath Hüber	Ja	1 T 6 Pf	-	-	-	-	4 Gr	3 Gr	-	13 Gr 6 Pf	4 Gr
1731	Vallrath Hüber	Ja	1 T 6 Pf	-	-	-	-	4 Gr	3 Gr	-	13 Gr 6 Pf	4 Gr
1732	Vollrath Hüber	Ja	1 T 6 Pf	-	-	-	-	4 Gr	3 Gr	-	13 Gr 6 Pf	4 Gr
1733	Vollrath Hüber	Ja	1 T 6 Pf	-	-	-	-	4 Gr	3 Gr	-	13 Gr 6 Pf	4 Gr
1734	Candidat Theologie Johann Gottfried Vierthaler	Ja	22 Gr 6 Pf	-	-	-	-	2 Gr	3 Gr	-	13 Gr 6 Pf	4 Gr
1735	Candid. Johann Gottfried Vierthaler	Ja	22 Gr 6 Pf	-	-	-	-	2 Gr	3 Gr	-	13 Gr 6 Pf	4 Gr
1736	Candid. der Theologie Johann Gottfried Vierthaler	Ja	1 T 6 Pf	-	-	-	2 Gr	2 Gr	3 Gr	-	13 Gr 6 Pf	4 Gr
1737	Candid. Johann Gottfried Vierthaler	Ja	1 T 6 Pf	-	-	-	2 Gr	2 Gr	3 Gr	-	13 Gr 6 Pf	4 Gr
1738	Candid. Johann Gottfried Vierthaler	Ja	1 T 6 Pf	-	-	-	2 Gr	2 Gr	3 Gr	-	13 Gr 6 Pf	4 Gr
1739	Candid.	Ja	1 T 6 Pf	-	-	-	2 Gr	2 Gr	3 Gr	-	13 Gr 6 Pf	4 Gr

# GH-Bachnetz

Literaturverzeichnis

Zurück zur Suche

Suchen:

## Person

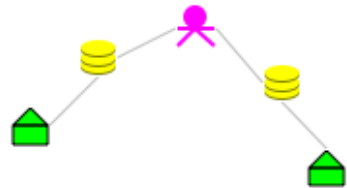

## Haus

Adresse Plan Kleiner 2 (Md 56, 1819: 376) (→Google Maps)  
 Viertel Magdeburger Viertel

Jahr	Name	Bezahlt	Summe	Opfer	Orgel	Schoß (vom Hause)	Wächter
1715	Vallrath Hüber	Nein	1 T 1 Gr	4 Gr	3 Gr	14 Gr	4 Gr
1716	Vallrath Hüber	Nein	1 T 1 Gr	4 Gr	3 Gr	14 Gr	4 Gr
1717	Vallrath Hüber	Nein	1 T 1 Gr	4 Gr	3 Gr	14 Gr	4 Gr
1718	Vallrath Hüber	Ja	1 T 1 Gr	4 Gr	3 Gr	14 Gr	4 Gr
1719	Vallrath Hüber	Ja	1 T 1 Gr	4 Gr	3 Gr	14 Gr	4 Gr

## Haus

Adresse Schulstraße 16 (Hall. 10,34, 1819: 292) (→Google Maps)  
 Viertel Hallisches Viertel

Jahr	Name	Bezahlt	Summe	Opfer	Orgel	Schoß (vom Hause)	Wächter
1730	Vallrath Hüber	Ja	1 T 6 Pf	4 Gr	3 Gr	13 Gr 6 Pf	4 Gr
1731	Vallrath Hüber	Ja	1 T 6 Pf	4 Gr	3 Gr	13 Gr 6 Pf	4 Gr



# GH-Bachnetz

Suchen:

Literaturverzeichnis  
Zurück zu: Haus

## Haus

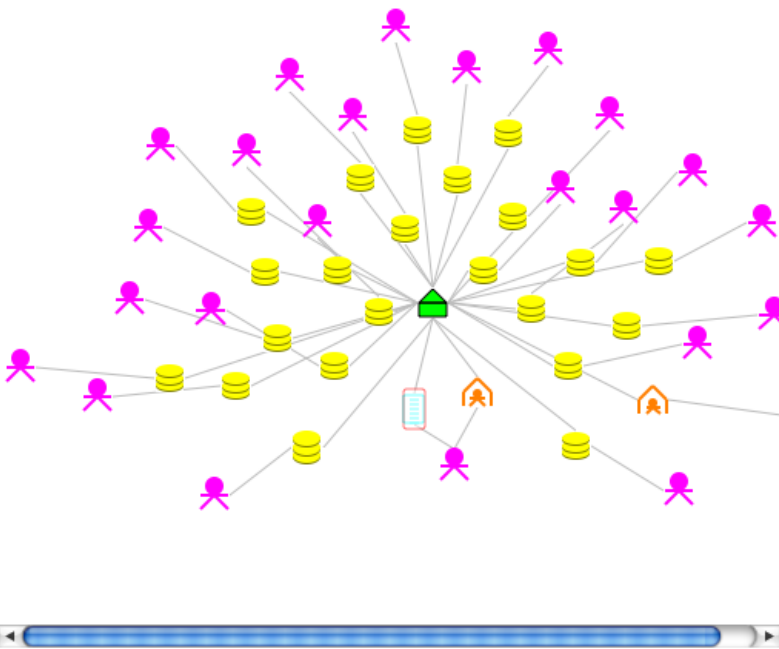

## Haus

Adresse Plan Kleiner 2 (Md 56, 1819: 376) (→Google Maps)  
Viertel Magdeburger Viertel

Jahr	Name	Bezahlt	Summe	Solleink.	Eink.	Brunnen	Flurh.	Kehr	Opfer	Orgel	Orgrel	Schoß (vom Hause)	Wächter
1710	Poleath Hüber	Nein	1 T 1 Gr 8 Pf	-	-	-	-	-	4 Gr 8 Pf	3 Gr	-	14 Gr	4 Gr
1711	Vallrath Hüber	Ja	1 T 1 Gr	-	-	-	-	-	4 Gr	3 Gr	-	14 Gr	4 Gr
1712	Vallrath Hüber	Ja	1 T 1 Gr	-	-	-	-	-	4 Gr	3 Gr	-	14 Gr	4 Gr
1713	Vallrath Hüber	Nein	1 T 1 Gr	-	-	-	-	-	4 Gr	3 Gr	-	14 Gr	4 Gr
1714	Vallrath Hüber	Nein	1 T 1 Gr	-	-	-	-	-	4 Gr	3 Gr	-	14 Gr	4 Gr
1715	Vallrath Hüber	Nein	1 T 1 Gr	-	-	-	-	-	4 Gr	3 Gr	-	14 Gr	4 Gr
1716	Vallrath Hüber	Nein	1 T 1 Gr	-	-	-	-	-	4 Gr	3 Gr	-	14 Gr	4 Gr
1717	Vallrath Hüber	Nein	1 T 1 Gr	-	-	-	-	-	4 Gr	3 Gr	-	14 Gr	4 Gr
1718	Vallrath Hüber	Ja	1 T 1 Gr	-	-	-	-	-	4 Gr	3 Gr	-	14 Gr	4 Gr
1719	Vallrath Hüber	Ja	1 T 1 Gr	-	-	-	-	-	4 Gr	3 Gr	-	14 Gr	4 Gr
1720	Nicolaus Schneider	Nein	1 T 1 Gr	-	-	-	-	-	4 Gr	3 Gr	-	14 Gr	4 Gr
1721	Nicolaus Schneider	Ja	1 T 1 Gr	-	-	-	-	-	4 Gr	3 Gr	-	14 Gr	4 Gr
1722	Nicolaus Schneider	Ja	1 T 1 Gr	-	-	-	-	-	4 Gr	3 Gr	-	14 Gr	4 Gr
1723	Nicolaus Schneider	Nein	1 T 1 Gr	-	-	-	-	-	4 Gr	3 Gr	-	14 Gr	4 Gr

## Hausbesitzer

Verknüpfungen  
Person: Vollrath Hübner  
Haus: Plan Kleiner 2 (Md 56, 1819: 376) (→Google Maps)

# Wallstraße 25/26

- Built 1719
  - Not 1712
    - similarity between digits 2 and 9

→ 27  
28  
– 29  
30

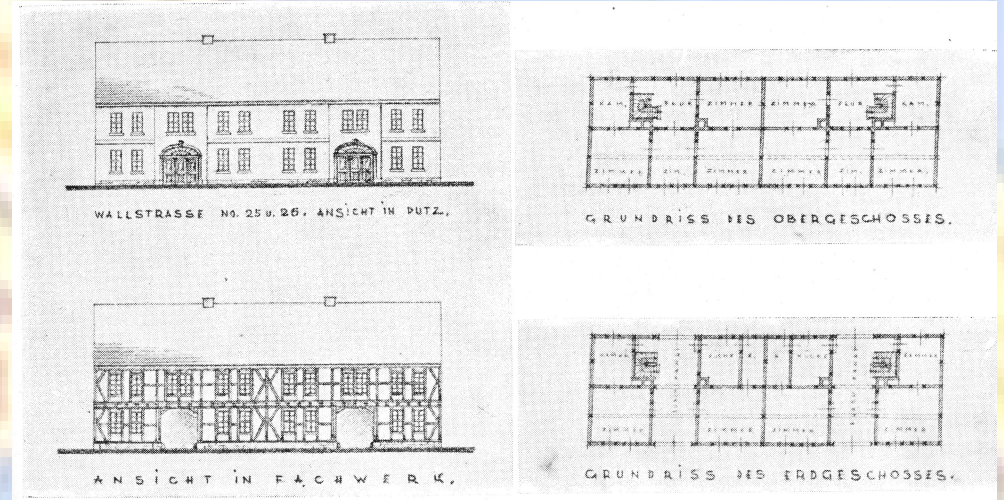

- Built by Johann Andreas Lautsch
- First renter Johann Sebastian Bach
- Second renter Hofrat Pfau





# Owners of Wallstraße 25/26

1713 – 1718	Johann Andreas Lautsch als Garten
1719 – 1729	Johann Andreas Lautsch (steuerfrei)
1730 – 1734	Johann Andreas Lautsch
1735 – 1741	Fr. Pfarrin Dorothea Sophia Baumlingerin
1742 – 1764	Fr. Hofräthin Pfauin und Erben
1765 – 1782	Hofrath Wolfgang Erhardt
1783 – 1819	Regierungsrat Ludwig Wilhelm Stötzer und Erben
ab 1875	Superindentur
seit 1966	Eigentum der katholischen Gemeinde, heute Teil des Pflegeheims St. Elisabeth

# Owners of Wallstraße 25/26

1713 – 1718	Johann Andreas Lautsch als Garten
1719 – 1729	Johann Andreas Lautsch (steuerfrei)
1730 – 1734	Johann Andreas Lautsch
1735 – 1741	Fr. Pfarrin Dorothea Sophia Baumlingerin
1742 – 1764	Fr. Hofräthin Pfauin und Erben
1765 – 1782	Hofrath Wolfgang Erhardt
1783 – 1819	Regierungsrat Ludwig Wilhelm Stötzer und Erben
ab 1875	Superintendentur
seit 1966	Eigentum der katholischen Gemeinde, heute Teil des Pflegeheims St. Elisabeth



- 
- The two houses of Lautsch
    - Schalaunische Straße 44
    - Wallstraße 25/26
  - ... have many positive hints on Johann Sebastian Bach
  - ... no not refutable negative statements

# The two homes of Johann-Sebastian Bach

- Initially:
  - Schalaunische Straße 44 at Krämer Johann Andreas Lautsch
- 1719 Lautsch built a new house in Wallstraße 25/26
  - Johann Sebastian Bach moved in





Georg Heeg eK

2nd Bach House

Bach Monument

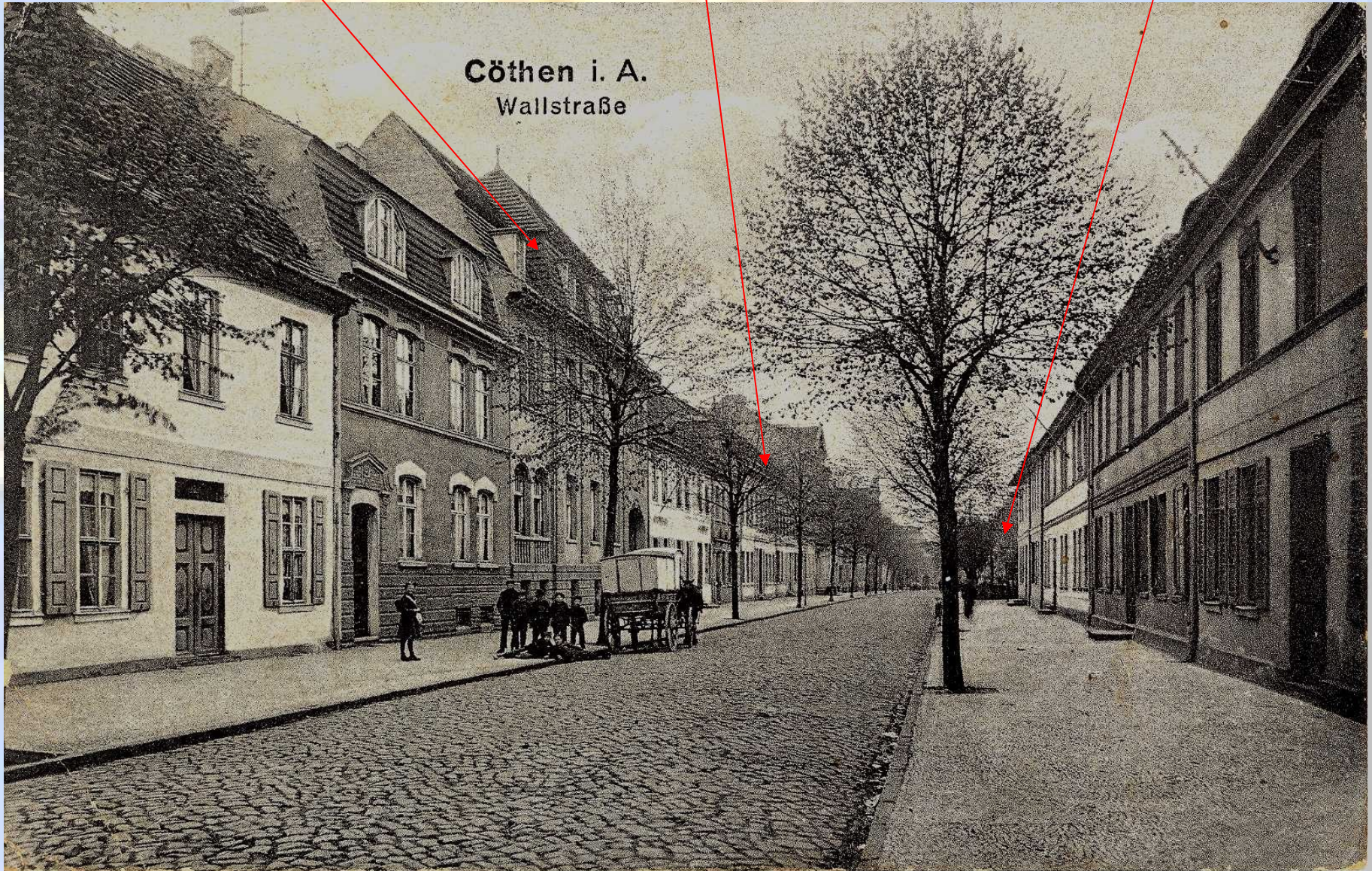

Cöthen i. A.  
Wallstraße



# Music Played at the Presentation

- <http://jan.ucc.nau.edu/~tas3/wtc/wtc.html>
- <http://jan.ucc.nau.edu/~tas3/wtc/i21.html#n>
- [http://www.classic-arietta.de/werke/johann\\_](http://www.classic-arietta.de/werke/johann_)